

BASE NETWORK

emme/2

LINKS:
mod=c
mod=t
mod=s
mod=h
&!i=1,1260
&!j=1,1260
COL-IND:UL1



WINDOW:
1445.3/135.899
1452.9/141.598

BASE NETWORK

emme/2

LINKS:
mod=c
mod=t
mod=s
mod=h
&!i=1,1260
&!j=1,1260
COL-IND:UL1



WINDOW:
1443.7/129.069
1453.3/136.273

EMME/2 PROJECT: 2000 Base Year Final Assignment Bank
SCENARIO 6719: copy of sc6706 for screenline volume plots

>>

02-03-23 12:18
MODULE: 2.13
DKS2000....rjs

BASE NETWORK

ATTRIB. @TOTVL: TOTAL VOL (SVOL+HVOL+(HTRKP+MTRKP)/1.7)

emme/2

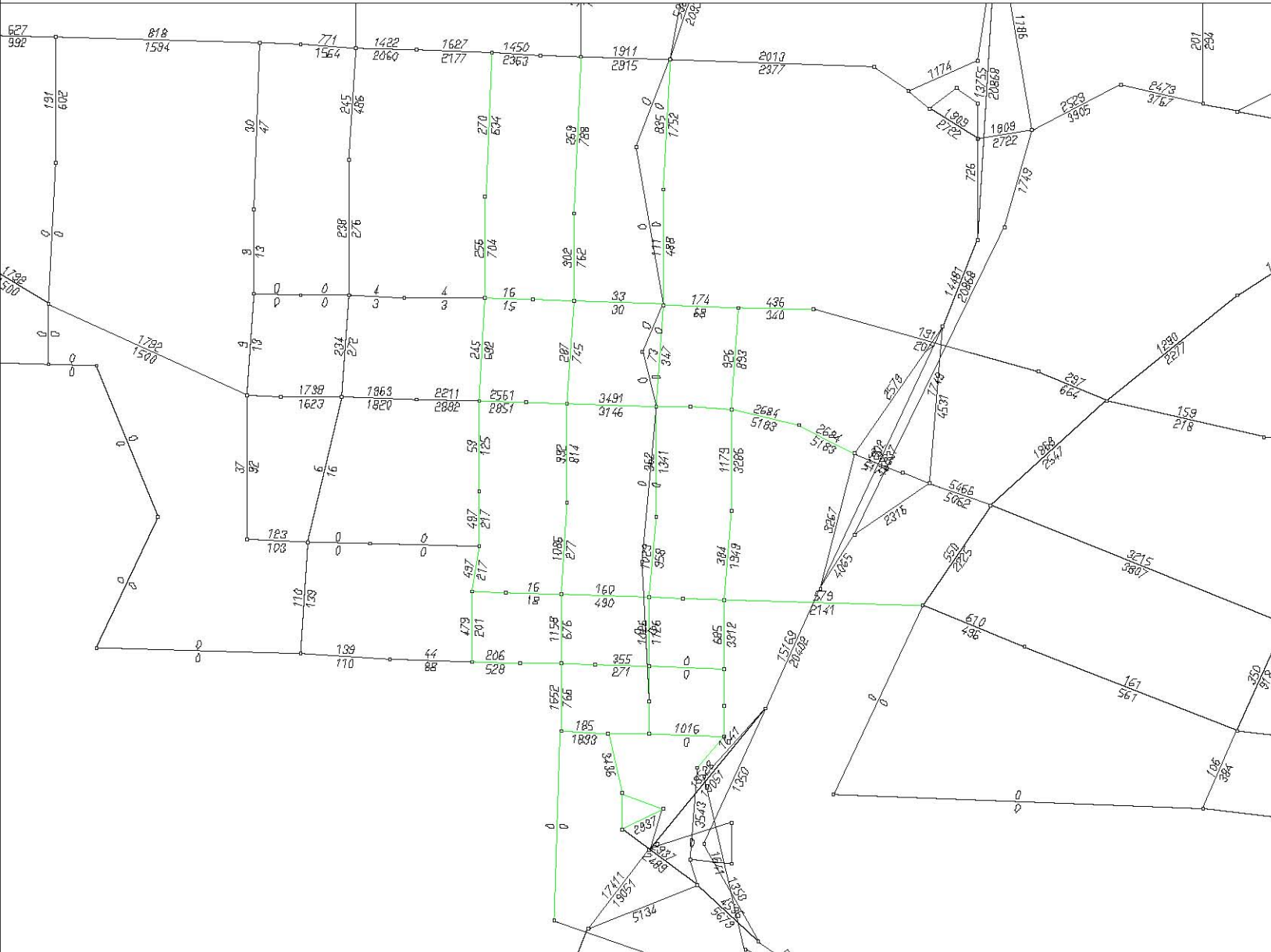

LINKS:
 mod=c
 mod=t
 mod=s
 mod=h
 &!i=1,1260
 &!j=1,1260
 COL-IND:UL1
 THRESHOLD:
 LOWER: -99999
 UPPER: 99999

WINDOW:
 1447.3/136.361
 1449.1/137.761

EMME/2 PROJECT: 2000 Base Year Final Assignment Bank
 SCENARIO 6719: copy of sc6706 for link color codes
 ATTRIB. @totvl: total vol (svol+hvol+(htrkp+mtrkp)/1.7)

02-03-23 14:37
 MODULE: r.13
 DKS2000....rjs

BASE NETWORK

ATTRIB. @TOTVL: TOTAL VOL (SVOL+HVOL+(HTRKP+MTRKP)/1.7)

emme/2

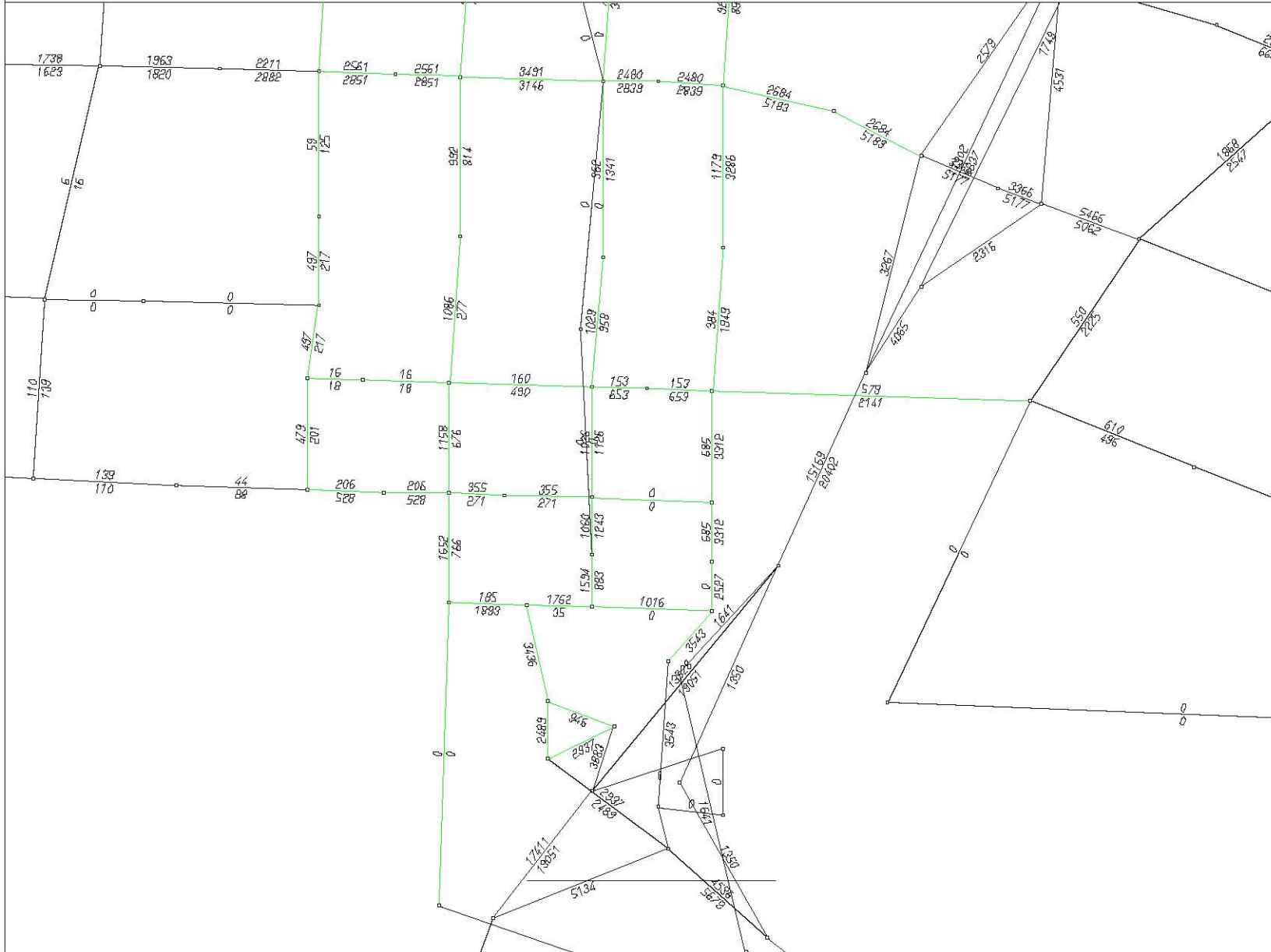

LINKS:

mod=c
mod=t
mod=s
mod=h
&!i=1,1260
&!j=1,1260

COL-IND:UL1

THRESHOLD:
LOWER: -99999
UPPER: 99999

WINDOW:
1447.7/136.369
1448.8/ 137.24

EMME/2 PROJECT: 2000 Base Year Final Assignment Bank
SCENARIO 6719: copy of sc6706 for link color codes
ATTRIB. @totvl: total vol (svol+hvol+(htrkp+mtrkp)/1.7)

02-03-23 14:34
MODULE: 2.13
DKS2000....rjs

BASE NETWORK

ATTRIB. @TOTVL: TOTAL VOL (SVOL+HVOL+(HTRKP+MTRKP)/1.7)

emme/2

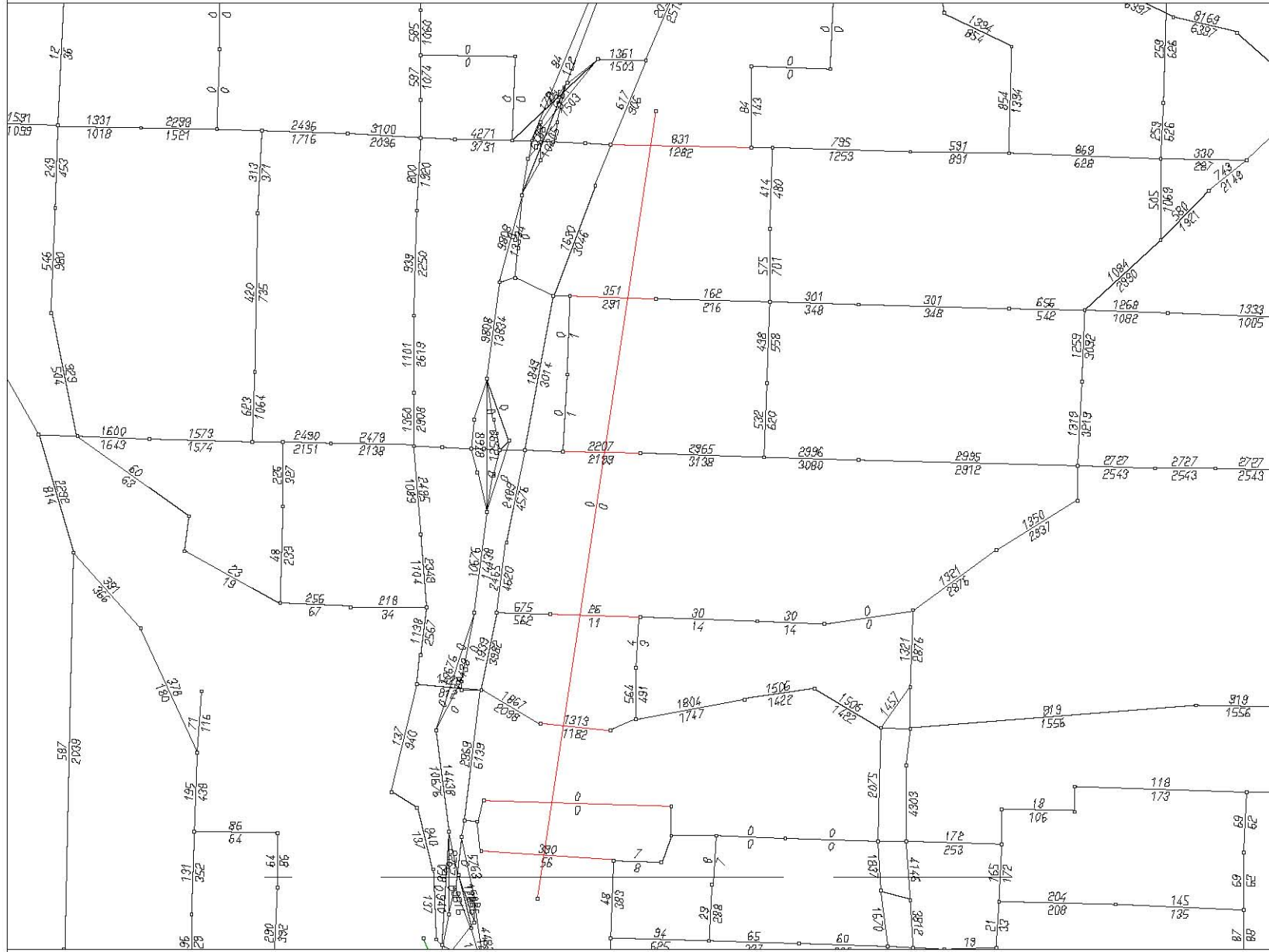

LINKS:
mod=c
mod=t
mod=s
mod=h
&!i=1,1260
&!j=1,1260
COL-IND:UL1
THRESHOLD:
LOWER: -99999
UPPER: 99999

WINDOW:
1447.2/138.763
1451.1/ 141.75

EMME/2 PROJECT: 2000 Base Year Final Assignment Bank
SCENARIO 6719: copy of sc6706 for screenline volume plots
ATTRIB. @totvl: total vol (svol+hvol+(htrkp+mtrkp)/1.7)

>>

02-03-23 12:19
MODULE: r.13
DKS2000....rjs

BASE NETWORK

ATTRIB. @TOTVL: TOTAL VOL (SVOL+HVOL+(HTRKP+MTRKP)/1.7)

emme/2

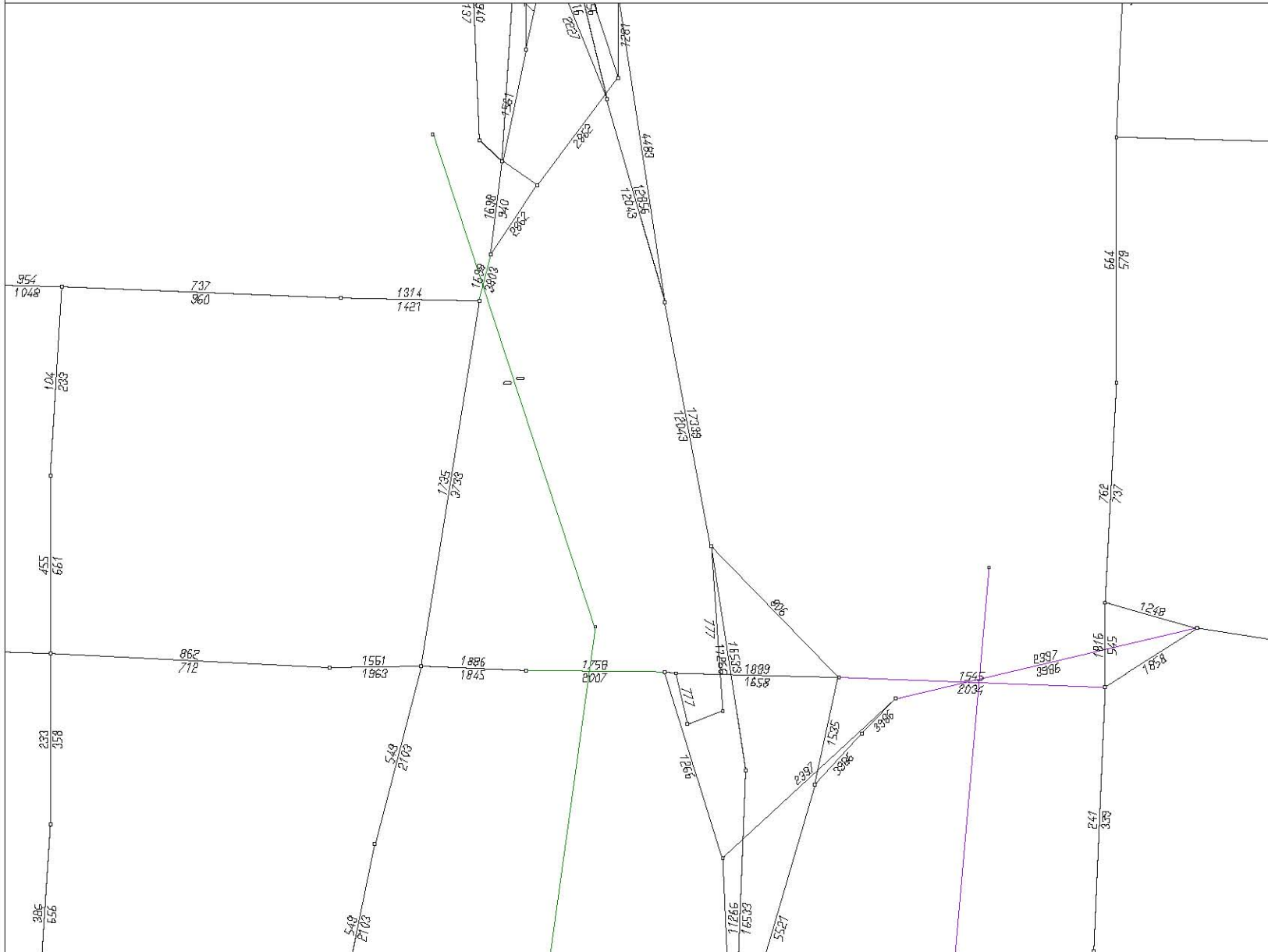

LINKS:
mod=c
mod=t
mod=s
mod=h
&!i=1,1260
&!j=1,1260

COL-IND:UL1

THRESHOLD:
LOWER: -99999
UPPER: 99999

WINDOW:
1448.1/ 138.09
1449.2/138.915

EMME/2 PROJECT: 2000 Base Year Final Assignment Bank
SCENARIO 6719: copy of sc6706 for screenline volume plots
ATTRIB. @totvl: total vol (svol+hvol+(htrkp+mtrkp)/1.7)

>>

02-03-23 12:20
MODULE: 2.13
DKS2000....rjs

BASE NETWORK

ATTRIB. @TOTVL: TOTAL VOL (SVOL+HVOL+(HTRKP+MTRKP)/1.7)

emme/2

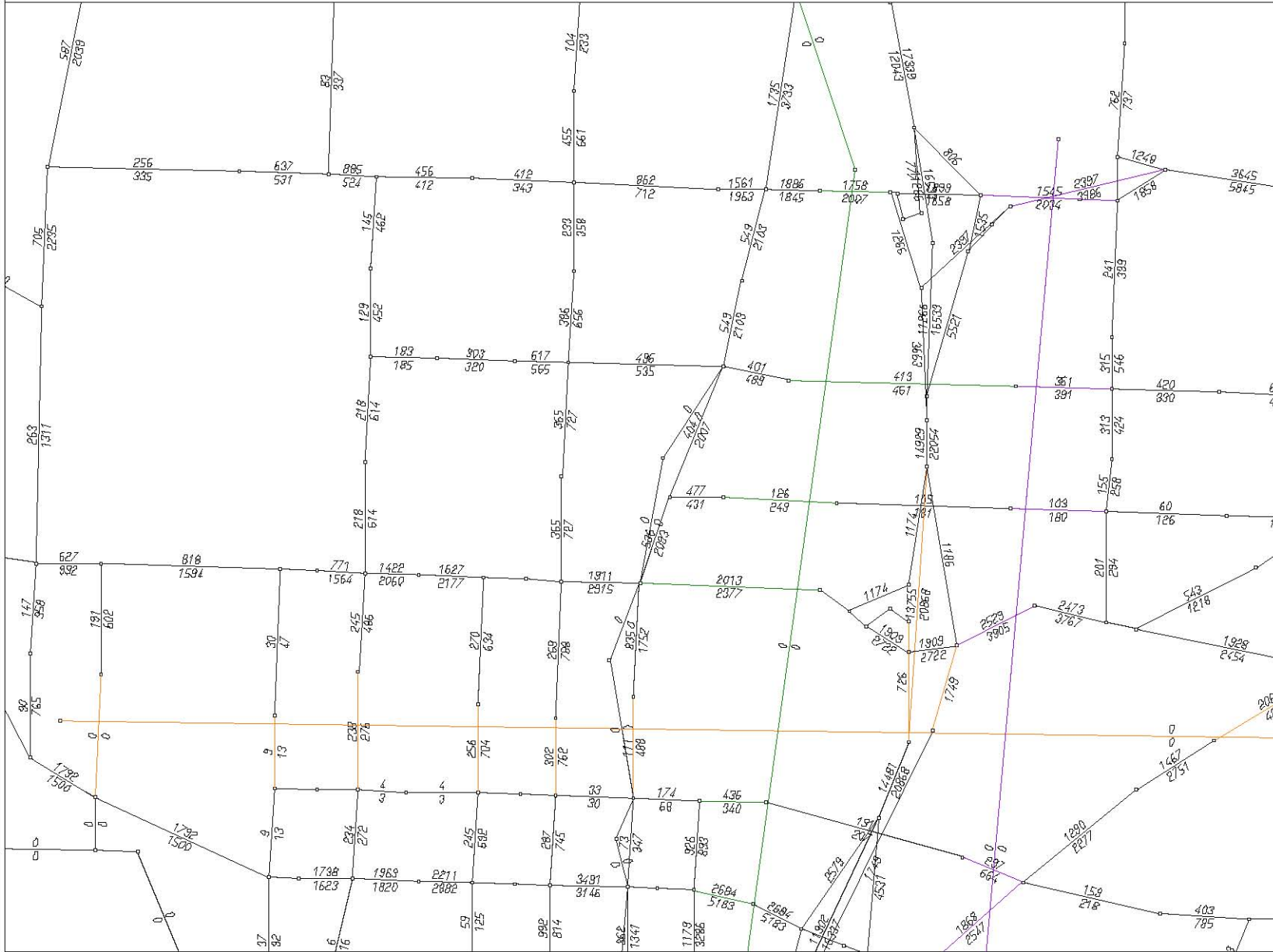

LINKS:
 mod=c
 mod=t
 mod=s
 mod=h
 &!i=1,1260
 &!j=1,1260
 COL-IND:UL1
 THRESHOLD:
 LOWER: -99999
 UPPER: 99999

WINDOW:
 1447.2/ 137.06
 1449.3/138.654

EMME/2 PROJECT: 2000 Base Year Final Assignment Bank
 SCENARIO 6719: copy of sc6706 for screenline volume plots
 ATTRIB. @totvl: total vol (svol+hvol+(htrkp+mtrkp)/1.7)

>>

02-03-23 12:20
 MODULE: r.13
 DKS2000....rjs

BASE NETWORK

ATTRIB. @TOTVL: TOTAL VOL (SVOL+HVOL+(HTRKP+MTRKP)/1.7)

emme/2

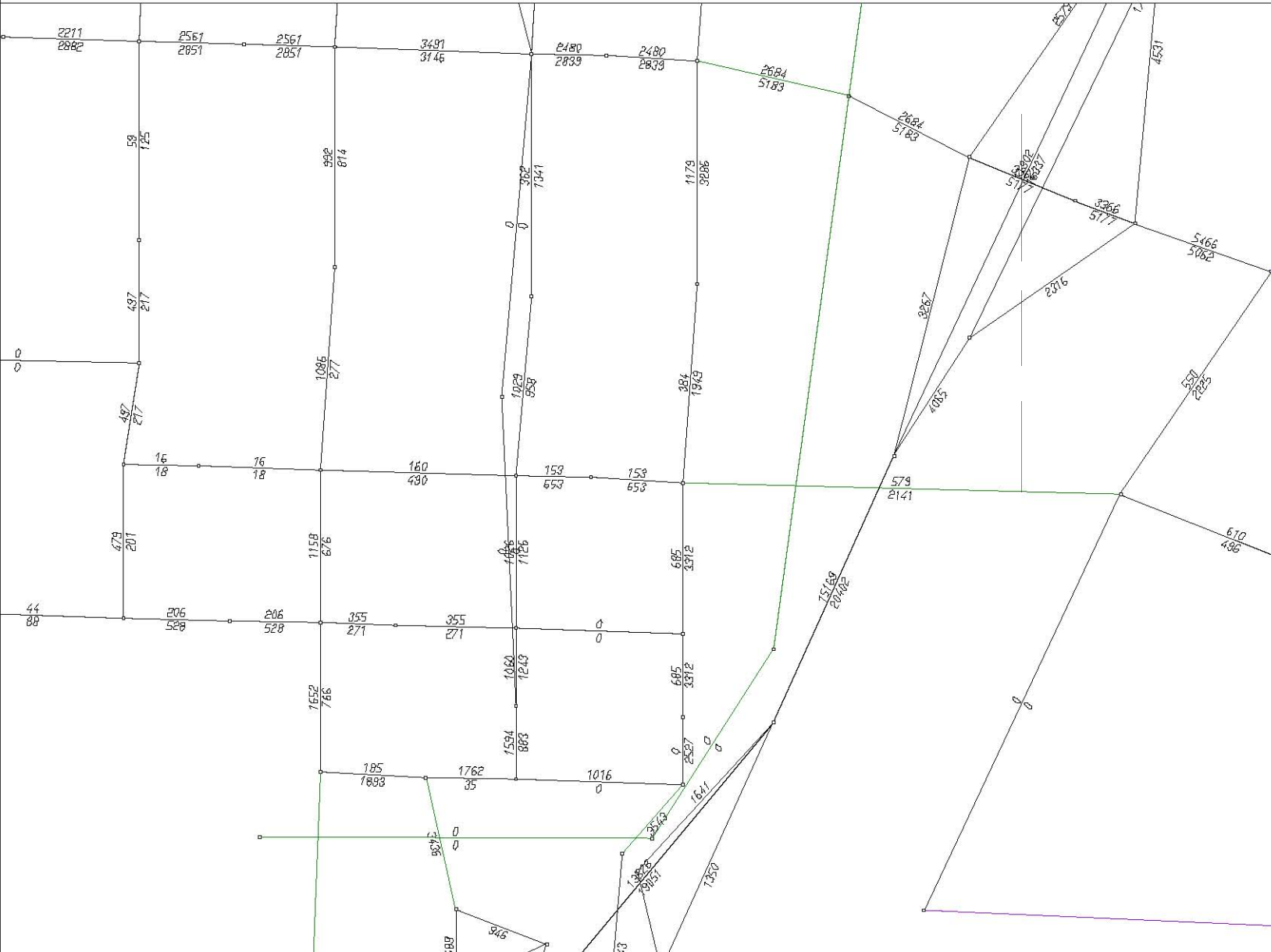

LINKS:
 mod=c
 mod=t
 mod=s
 mod=h
 &!i=1,1260
 &!j=1,1260
 COL-IND:UL1
 THRESHOLD:
 LOWER: -99999
 UPPER: 99999

WINDOW:
 1447.9/136.569
 1448.7/137.202

EMME/2 PROJECT: 2000 Base Year Final Assignment Bank
 SCENARIO 6719: copy of sc6706 for screenline volume plots
 ATTRIB. @totvl: total vol (svol+hvol+(htrkp+mtrkp)/1.7)

>>

02-03-23 12:21
 MODULE: 2.13
 DKS2000....rjs

BASE NETWORK

ATTRIB. @TOTVL: TOTAL VOL (SVOL+HVOL+(HTRKP+MTRKP)/1.7)

emme/2

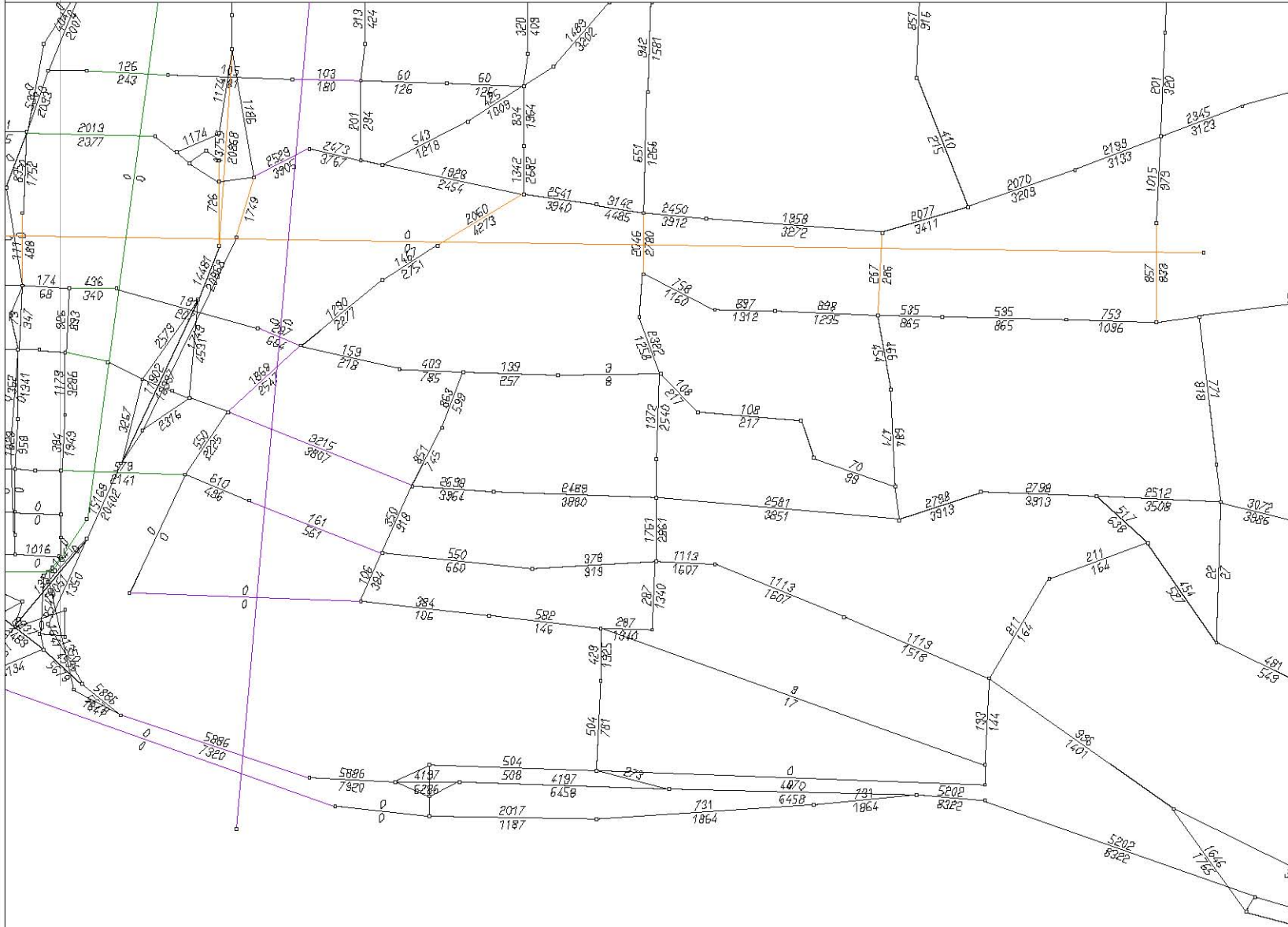

LINKS:
 mod=c
 mod=t
 mod=s
 mod=h
 &!i=1,1260
 &!j=1,1260
 COL-IND:UL1
 THRESHOLD:
 LOWER: -99999
 UPPER: 99999

WINDOW:
 1448.2/135.728
 1451.2/137.983

EMME/2 PROJECT: 2000 Base Year Final Assignment Bank
 SCENARIO 6719: copy of sc6706 for screenline volume plots
 ATTRIB. @totvl: total vol (svol+hvol+(htrkp+mtrkp)/1.7)

>>

02-03-23 12:21
 MODULE: r.13
 DKS2000....rjs

BASE NETWORK

ATTRIB. @TOTVL: TOTAL VOL (SVOL+HVOL+(HTRKP+MTRKP)/1.7)

emme/2

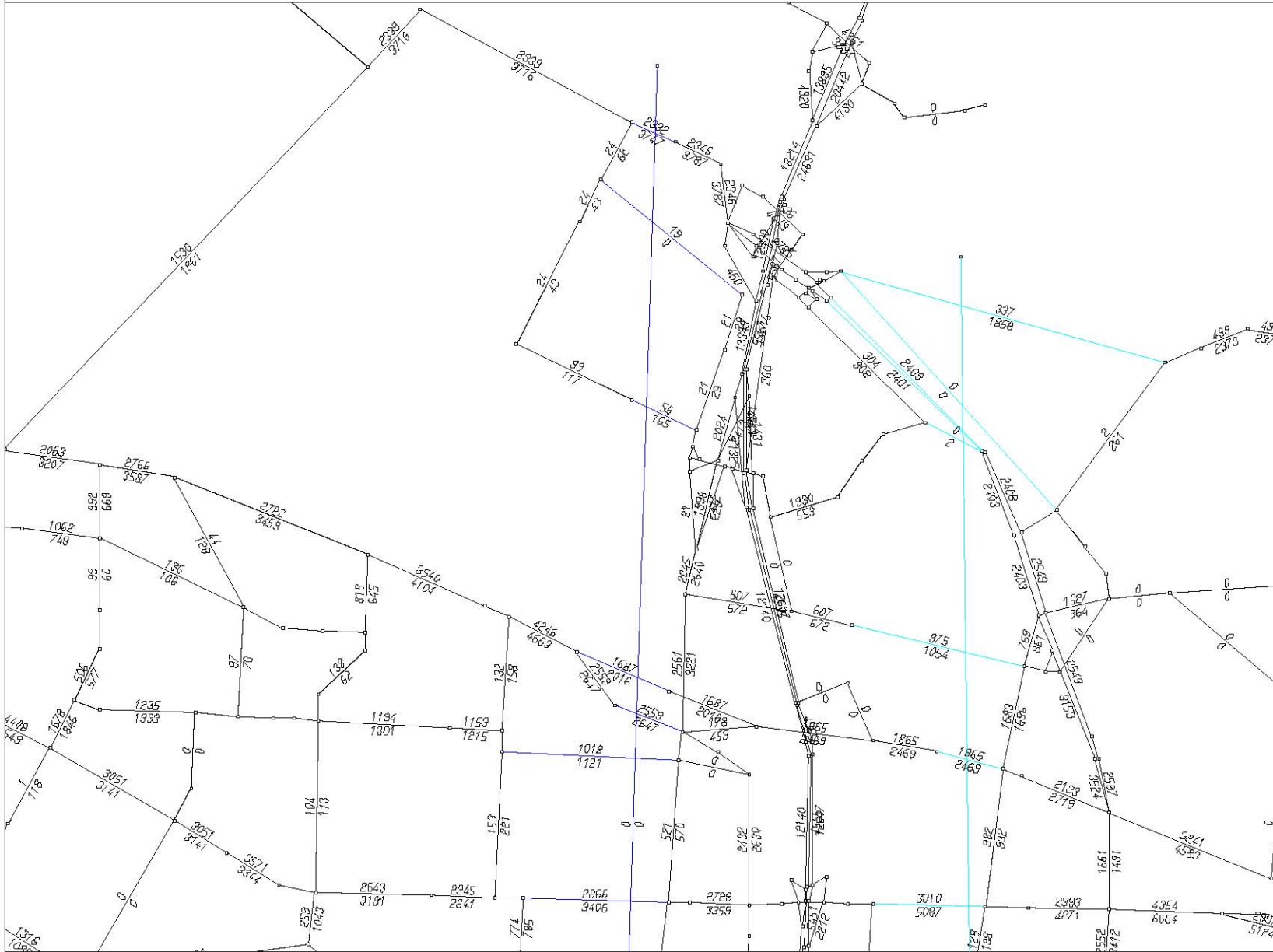

LINKS:

- mod=c
- mod=t
- mod=s
- mod=h

&!i=1,1260
&!j=1,1260

COL-IND:UL1

THRESHOLD:

LOWER: -99999
UPPER: 99999

WINDOW:

1445.5/133.209
1449.1/135.908

EMME/2 PROJECT: 2000 Base Year Final Assignment Bank
SCENARIO 6719: copy of sc6706 for screenline volume plots
ATTRIB. @totvl: total vol (svol+hvol+(htrkp+mtrkp)/1.7)

>>

02-03-23 12:22
MODULE: r.13
DKS2000....rjs

BASE NETWORK

ATTRIB. @TOTVL: TOTAL VOL (SVOL+HVOL+(HTRKP+MTRKP)/1.7)

emme/2

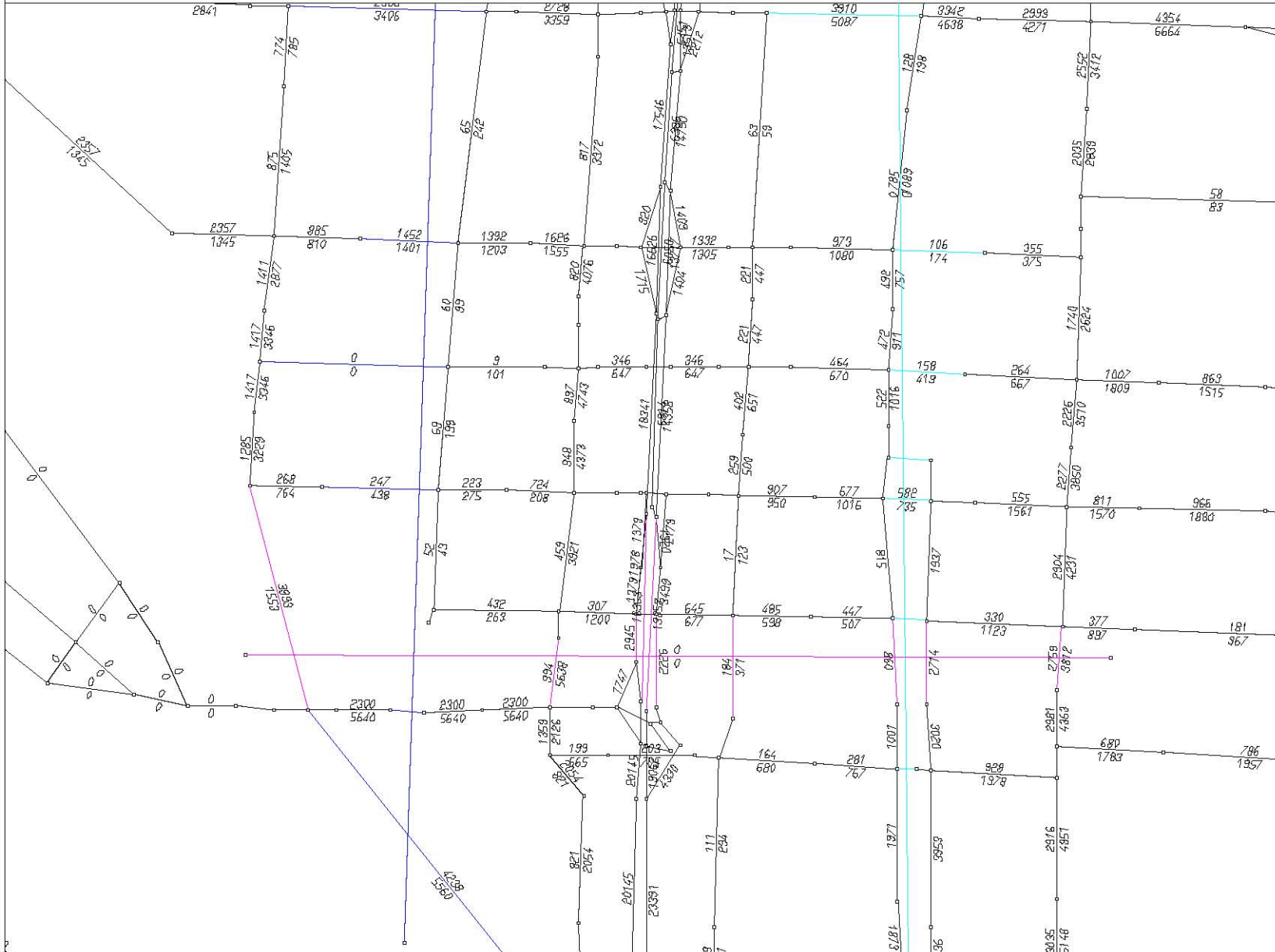

LINKS:
 mod=c
 mod=t
 mod=s
 mod=h
 &!i=1,1260
 &!j=1,1260

COL-IND:UL1

THRESHOLD:
 LOWER: -99999
 UPPER: 99999

WINDOW:
 1446.4/131.389
 1449/133.366

EMME/2 PROJECT: 2000 Base Year Final Assignment Bank
 SCENARIO 6719: copy of sc6706 for screenline volume plots
 ATTRIB. @totvl: total vol (svol+hvol+(htrkp+mtrkp)/1.7)

>>

02-03-23 12:22
 MODULE: r.13
 DKS2000....rjs

BASE NETWORK

ATTRIB. @TOTVL: TOTAL VOL (SVOL+HVOL+(HTRKP+MTRKP)/1.7)

emme/2

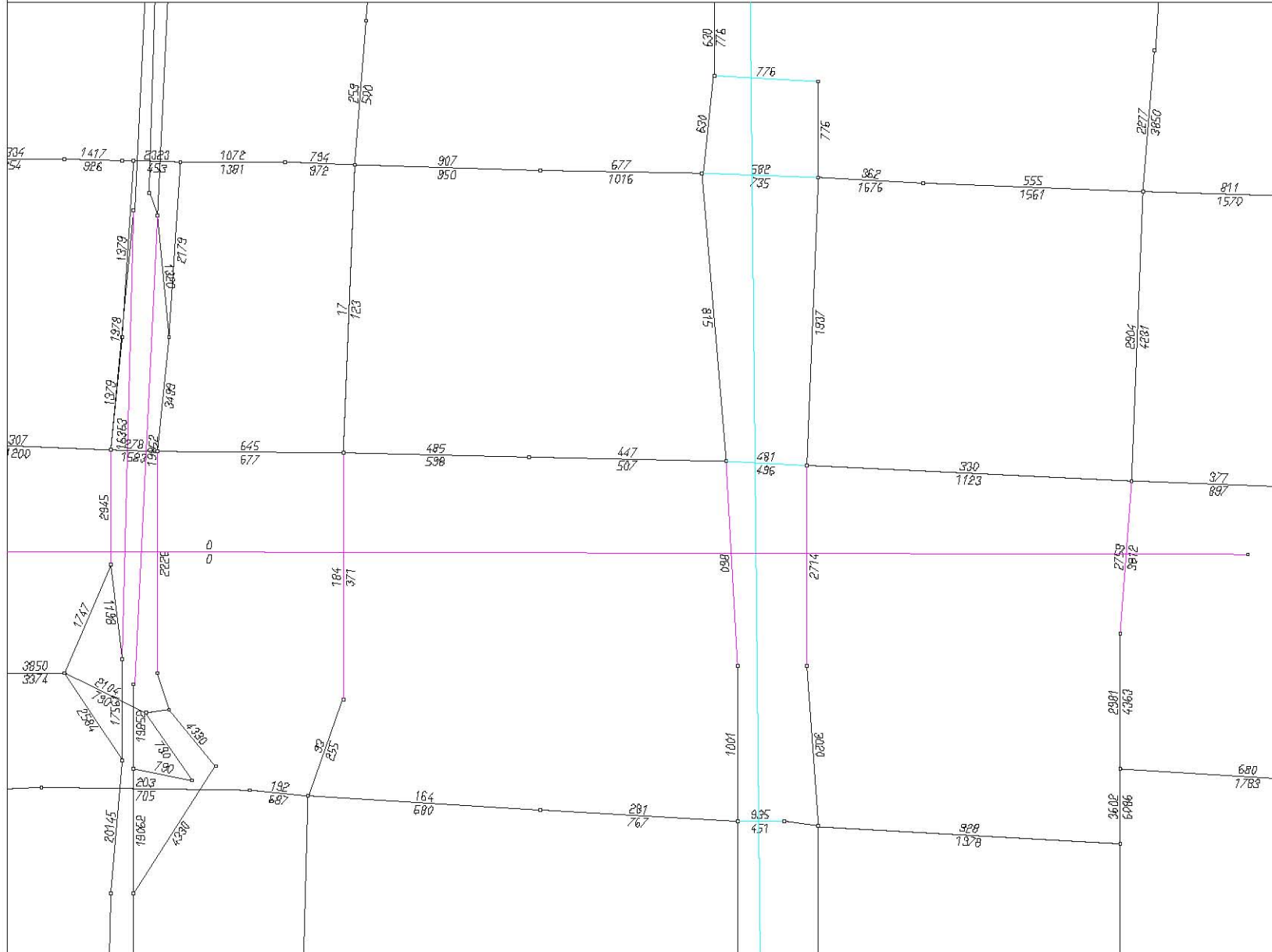

LINKS:

```

mod=c
mod=t
mod=s
mod=h
&!i=1,1260
&!j=1,1260
    
```

COL-IND:UL1

THRESHOLD:
 LOWER: -99999
 UPPER: 99999

WINDOW:
 1447.6/131.662
 1448.7/132.486

BASE NETWORK

ATTRIB. @TOTVL: TOTAL VOL (SVOL+HVOL+(HTRKP+MTRKP)/1.7)

emme/2

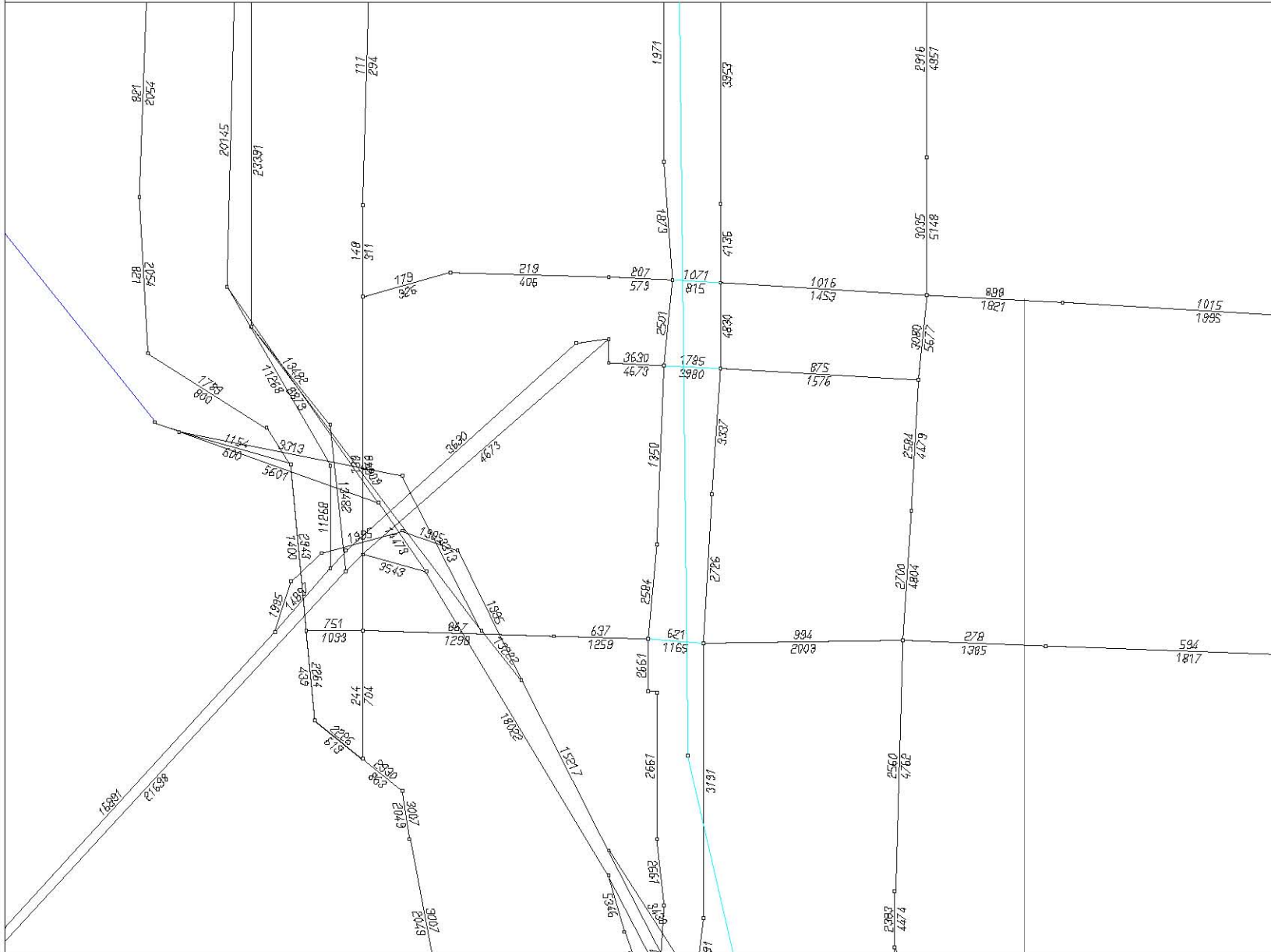

LINKS:
mod=c
mod=t
mod=s
mod=h
&!i=1,1260
&!j=1,1260
COL-IND:UL1
THRESHOLD:
LOWER: -99999
UPPER: 99999

WINDOW:
1447.4/130.503
1449/131.703

EMME/2 PROJECT: 2000 Base Year Final Assignment Bank
SCENARIO 6719: copy of sc6706 for screenline volume plots
ATTRIB. @totvl: total vol (svol+hvol+(htrkp+mtrkp)/1.7)

>>

02-03-23 12:23
MODULE: 2.13
DKS2000....rjs

BASE NETWORK

ATTRIB. @TOTVL: TOTAL VOL (SVOL+HVOL+(HTRKP+MTRKP)/1.7)

emme/2

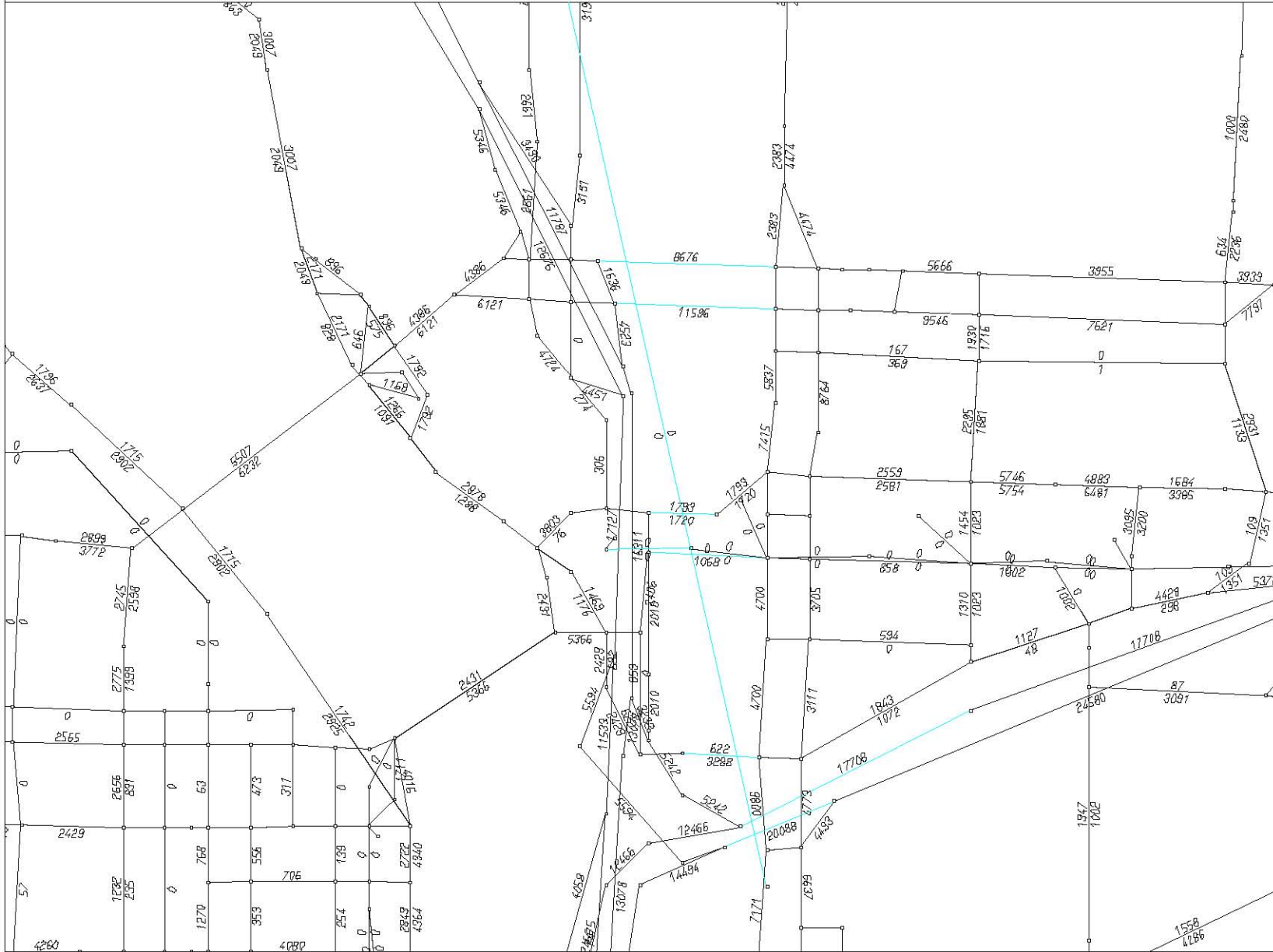

LINKS:
mod=c
mod=t
mod=s
mod=h
&!i=1,1260
&!j=1,1260
COL-IND:UL1
THRESHOLD:
LOWER: -99999
UPPER: 99999

WINDOW:
1447.6/129.603
1449.1/130.728

EMME/2 PROJECT: 2000 Base Year Final Assignment Bank
SCENARIO 6719: copy of sc6706 for screenline volume plots
ATTRIB. @totvl: total vol (svol+hvol+(htrkp+mtrkp)/1.7)

>>

02-03-23 12:24
MODULE: r.13
DKS2000....rjs