

# BASE NETWORK

emme/2

LINKS:  
mod=c  
mod=t  
mod=s  
mod=h  
&!i=1,1260  
&!j=1,1260  
COL-IND:UL1



WINDOW:  
1445.3/135.899  
1452.9/141.598

# BASE NETWORK

emme/2



LINKS:  
mod=c  
mod=t  
mod=s  
mod=h  
&!i=1,1260  
&!j=1,1260  
COL-IND:UL1

WINDOW:  
1443.7/129.069  
1453.3/136.273

EMME/2 PROJECT: I-5 Trade Corridor Phase II Modeling  
SCENARIO 7520: copy of sc7507 for link color codes

>>

02-03-23 15:03  
MODULE: 2.13  
DKS2000....rjs



# BASE NETWORK

ATTRIB. @TOTVL: TOTAL VOL (SVOL+HVOL+(HTRKP+MTRKP)/1.7)

emme/2

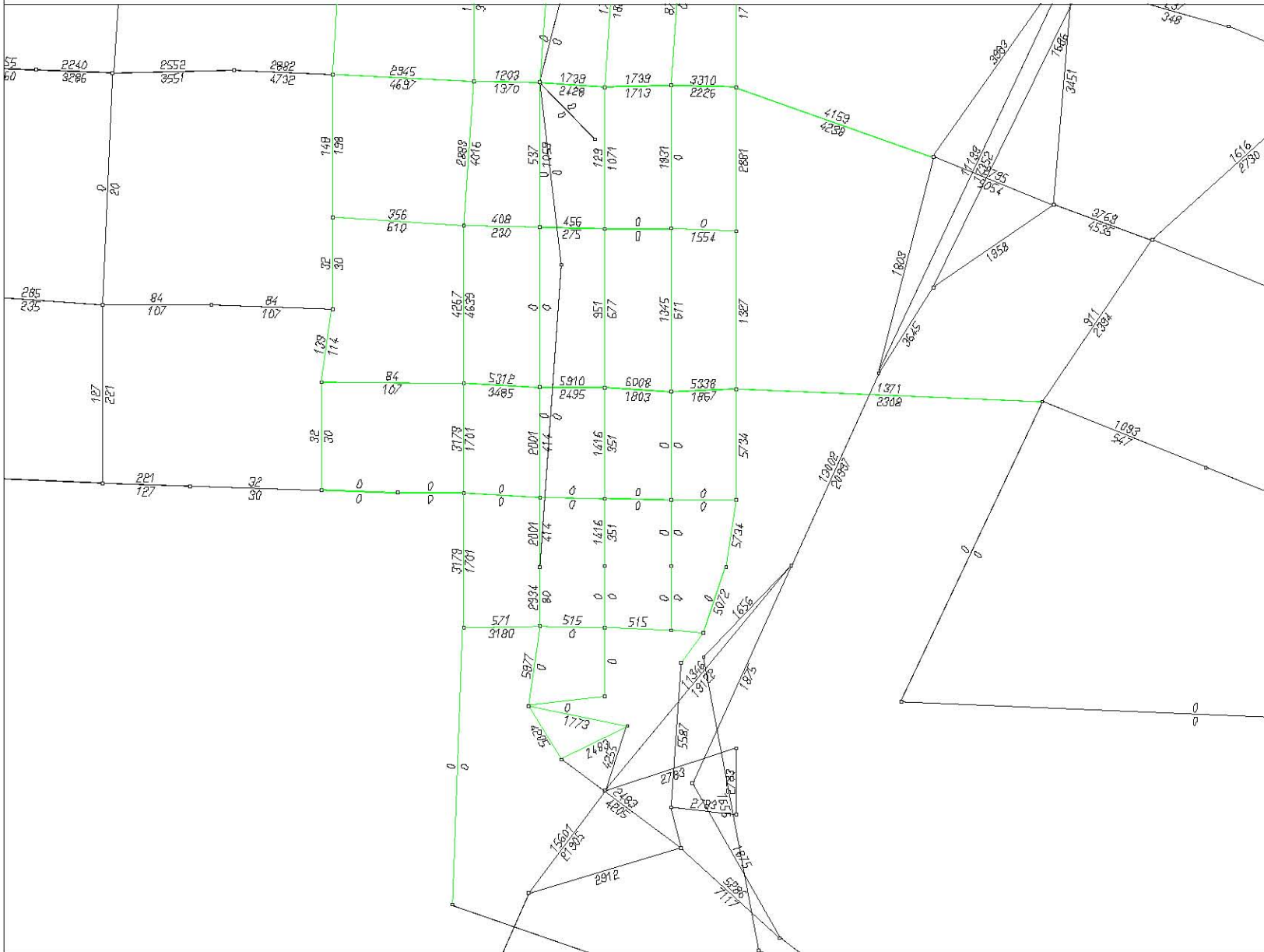

LINKS:

mod=c  
 mod=t  
 mod=s  
 mod=h  
 &!i=1,1260  
 &!j=1,1260

COL-IND:UL1

THRESHOLD:  
 LOWER: -99999  
 UPPER: 99999

WINDOW:  
 1447.7/136.369  
 1448.8/ 137.24

# BASE NETWORK

ATTRIB. @TOTVL: TOTAL VOL (SVOL+HVOL+(HTRKP+MTRKP)/1.7)

emme/2

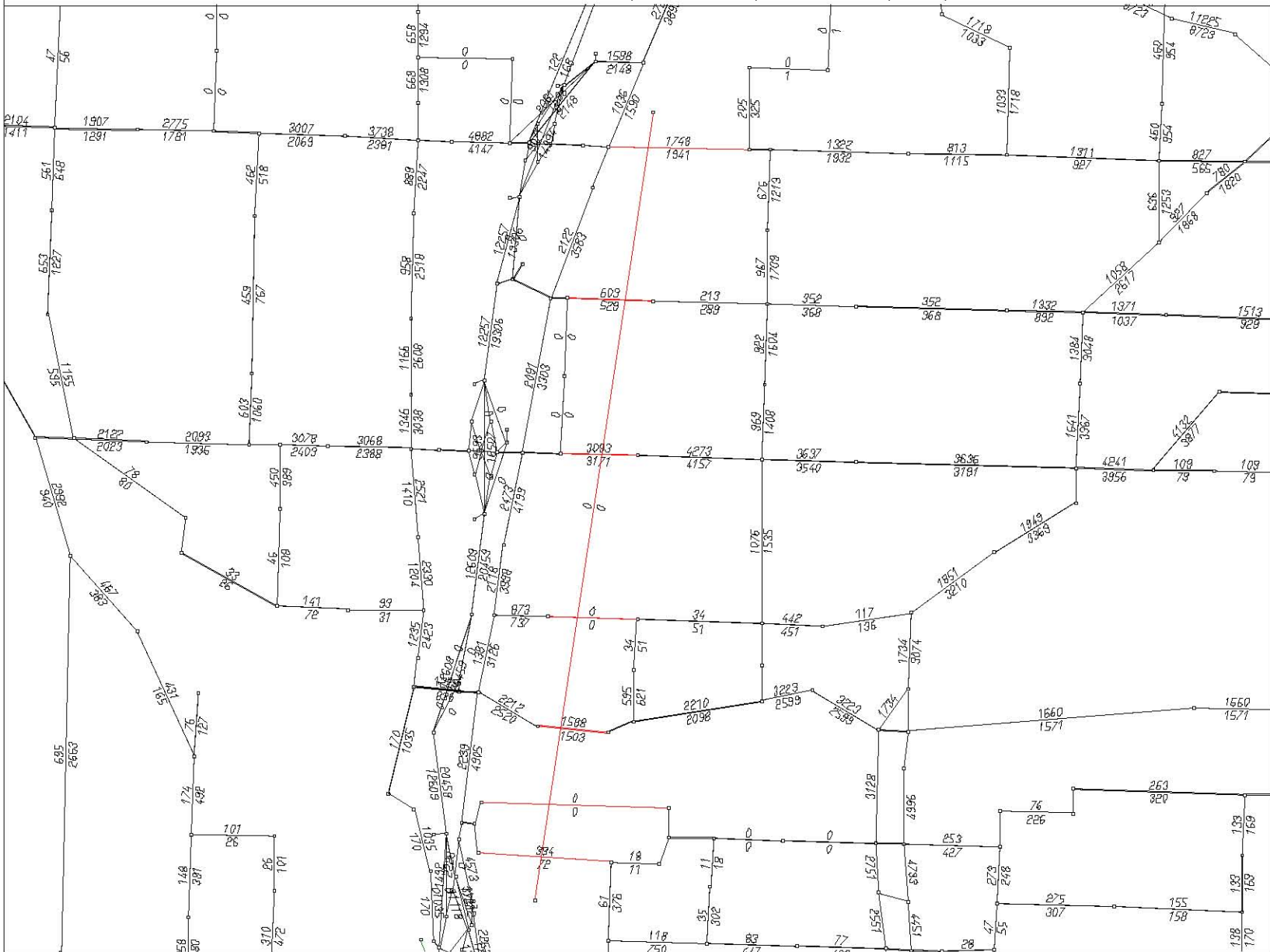

LINKS:  
mod=c  
mod=t  
mod=s  
mod=h  
&!i=1,1260  
&!j=1,1260  
COL-IND:UL1  
THRESHOLD:  
LOWER: -99999  
UPPER: 99999

WINDOW:  
1447.2/138.763  
1451.1/ 141.75

EMME/2 PROJECT: I-5 Trade Corridor Phase II Modeling  
SCENARIO 7520: copy of sc7507 for link color codes  
ATTRIB. @totvl: total vol (svol+hvol+(htrkp+mtrkp)/1.7)

>>

02-03-23 15:04  
MODULE: r.13  
DKS2000....rjs



# BASE NETWORK

ATTRIB. @TOTVL: TOTAL VOL (SVOL+HVOL+(HTRKP+MTRKP))/1.7)

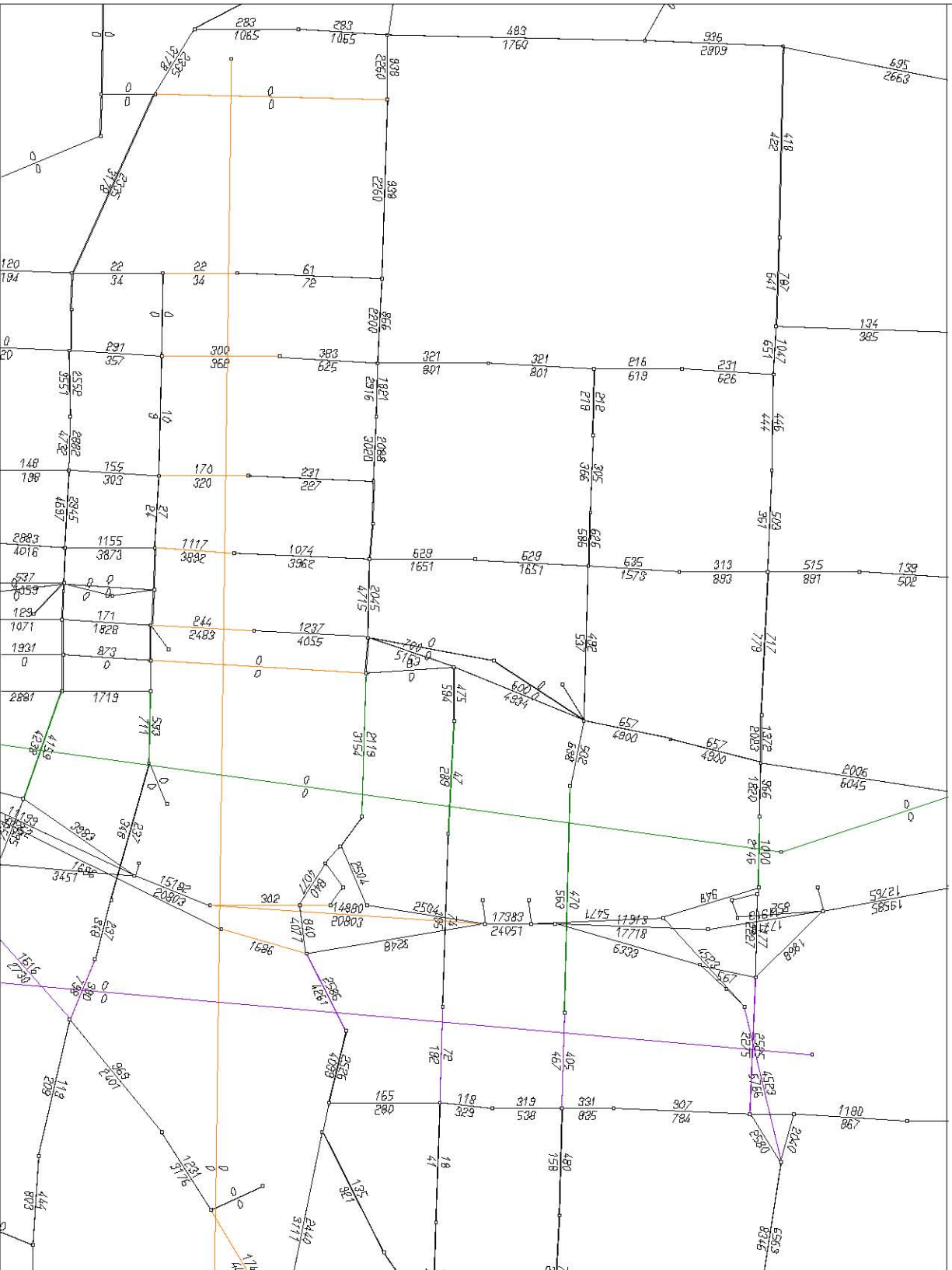

*emme/2*

LINKS:  
 mod=c  
 mod=l  
 mod=s  
 mod=h  
 & i=1,1260  
 & j=1,1260  
 COL-IND: UTL  
 THRESHOLD:  
 LOWER: -99999  
 UPPER: 99999

WINDOW:  
 1447.2/ 137.06  
 1449.3/138.654

02-03-23 15:05  
 MODULE: 2.13  
 DKS2000...r.js

EMME/2 PROJECT: I-5 Trade Corridor Phase II Modeling  
 SCENARIO 7520: copy of sc7507 for link color codes  
 ATTRIB. @totvl: total vol (svol+hvol+(htrkp+mtrkp))/1.7)

# BASE NETWORK

ATTRIB. @TOTVL: TOTAL VOL (SVOL+HVOL+(HTRKP+MTRKP)/1.7)

emme/2

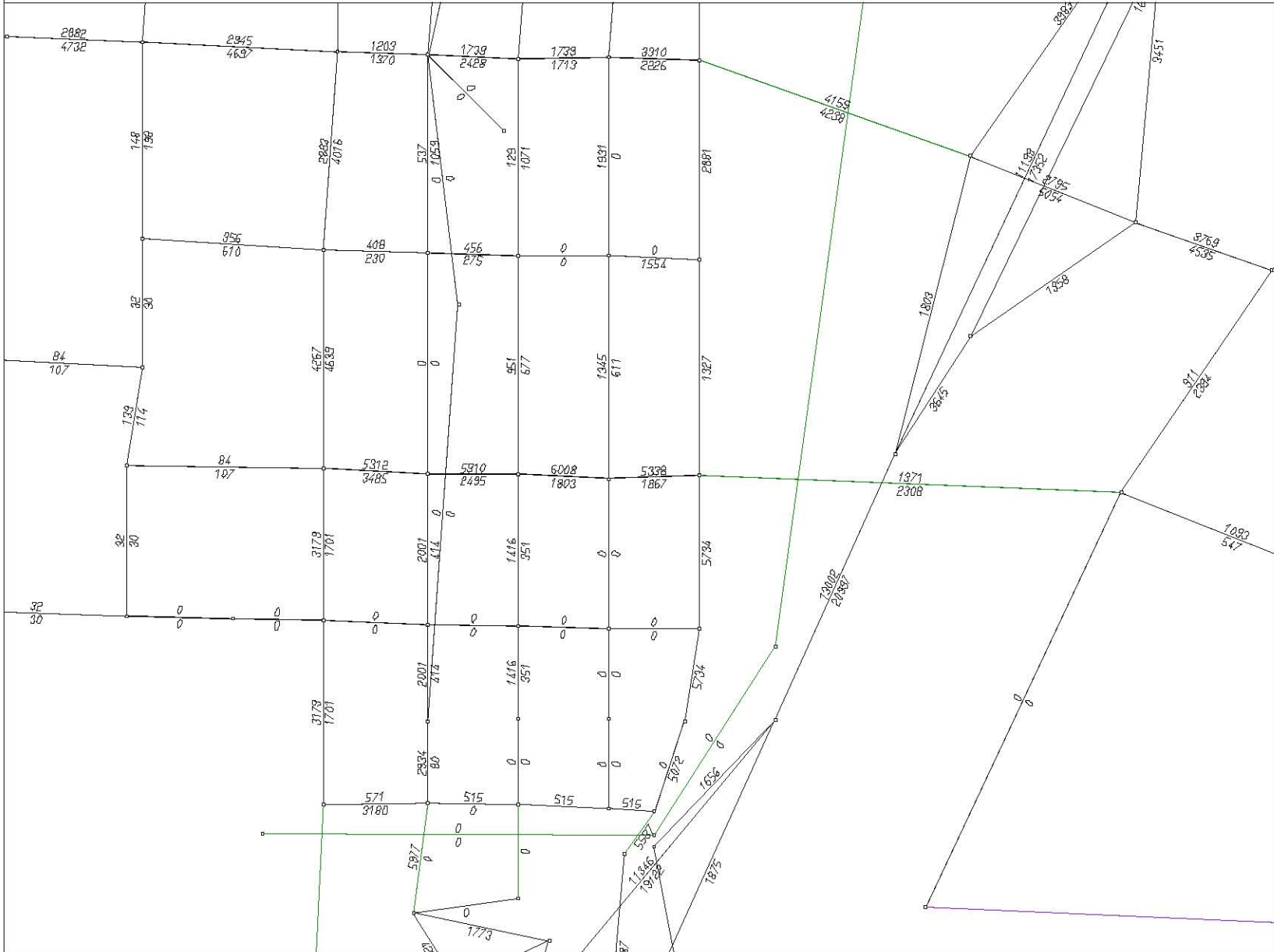

LINKS:

- mod=c
- mod=t
- mod=s
- mod=h
- &!i=1,1260
- &!j=1,1260

COL-IND:UL1

THRESHOLD:

LOWER: -99999

UPPER: 99999

WINDOW:

1447.9/136.569

1448.7/137.202



# BASE NETWORK

ATTRIB. @TOTVL: TOTAL VOL (SVOL+HVOL+(HTRKP+MTRKP)/1.7)

emme/2

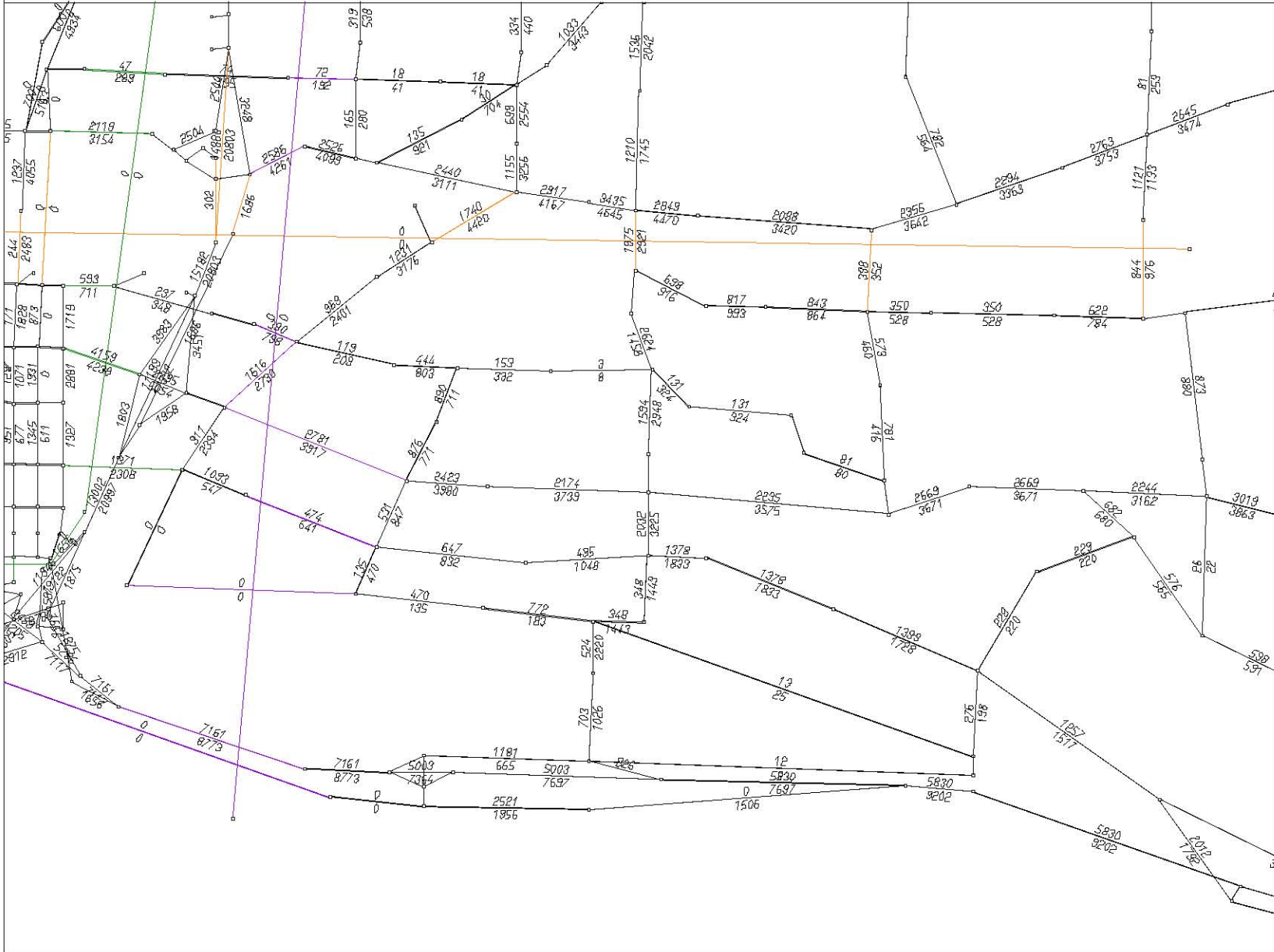

LINKS:  
mod=c  
mod=t  
mod=s  
mod=h  
&!i=1,1260  
&!j=1,1260  
COL-IND:UL1  
THRESHOLD:  
LOWER: -99999  
UPPER: 99999

WINDOW:  
1448.2/135.728  
1451.2/137.983

EMME/2 PROJECT: I-5 Trade Corridor Phase II Modeling  
SCENARIO 7520: copy of sc7507 for link color codes  
ATTRIB. @totvl: total vol (svol+hvol+(htrkp+mtrkp)/1.7)

>>

02-03-23 15:10  
MODULE: 2.13  
DKS2000....rjs

# BASE NETWORK

ATTRIB. @TOTVL: TOTAL VOL (SVOL+HVOL+(HTRKP+MTRKP)/1.7)

emme/2

LINKS:

mod=c  
mod=t  
mod=s  
mod=h  
&!i=1,1260  
&!j=1,1260

COL-IND:UL1

THRESHOLD:  
LOWER: -99999  
UPPER: 99999

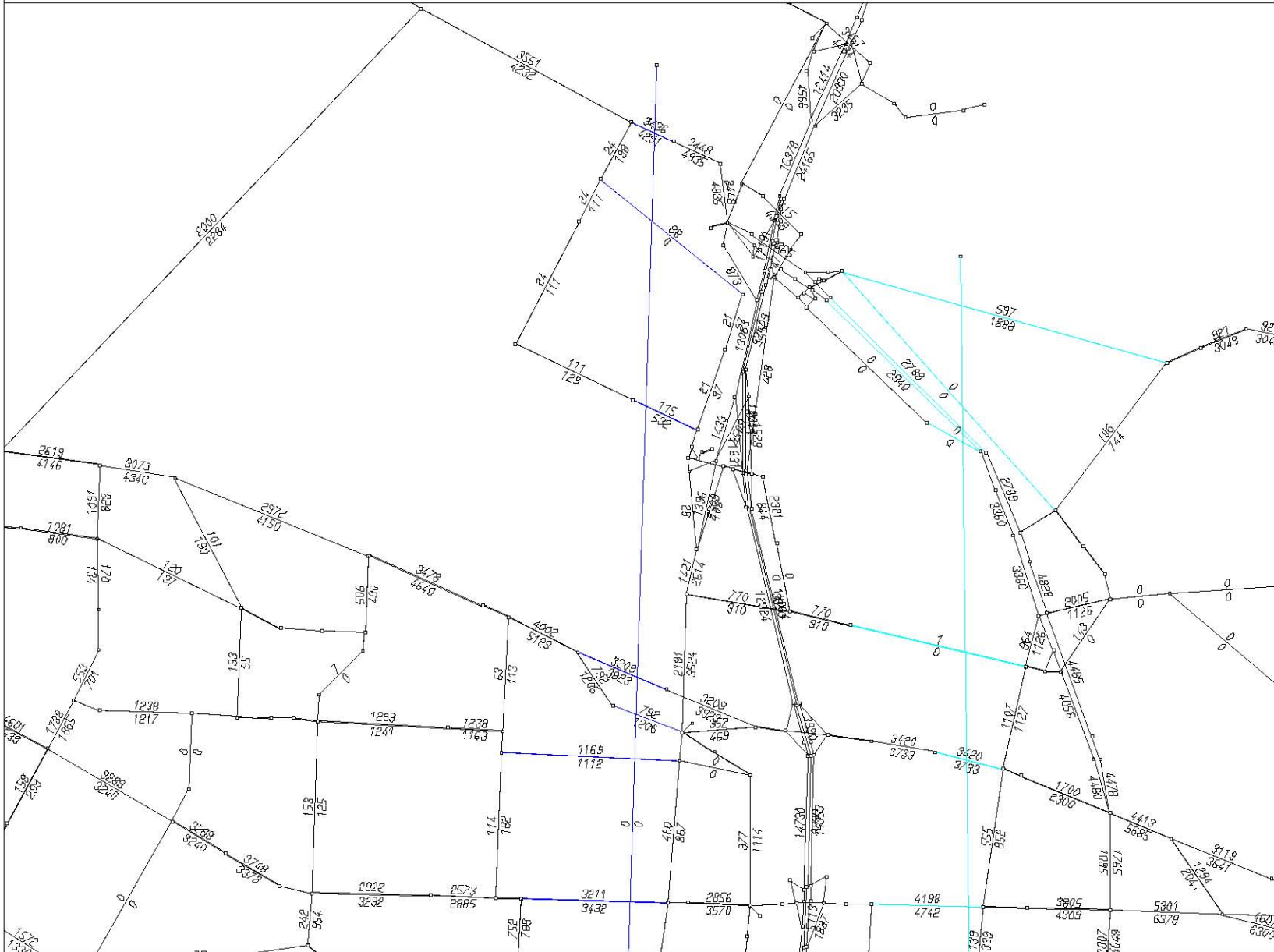

WINDOW:  
1445.5/133.209  
1449.1/135.908

EMME/2 PROJECT: I-5 Trade Corridor Phase II Modeling  
SCENARIO 7520: copy of sc7507 for link color codes  
ATTRIB. @totvl: total vol (svol+hvol+(htrkp+mtrkp)/1.7)

>>

02-03-23 15:11  
MODULE: 2.13  
DKS2000....rjs

# BASE NETWORK

ATTRIB. @TOTVL: TOTAL VOL (SVOL+HVOL+(HTRKP+MTRKP)/1.7)

emme/2

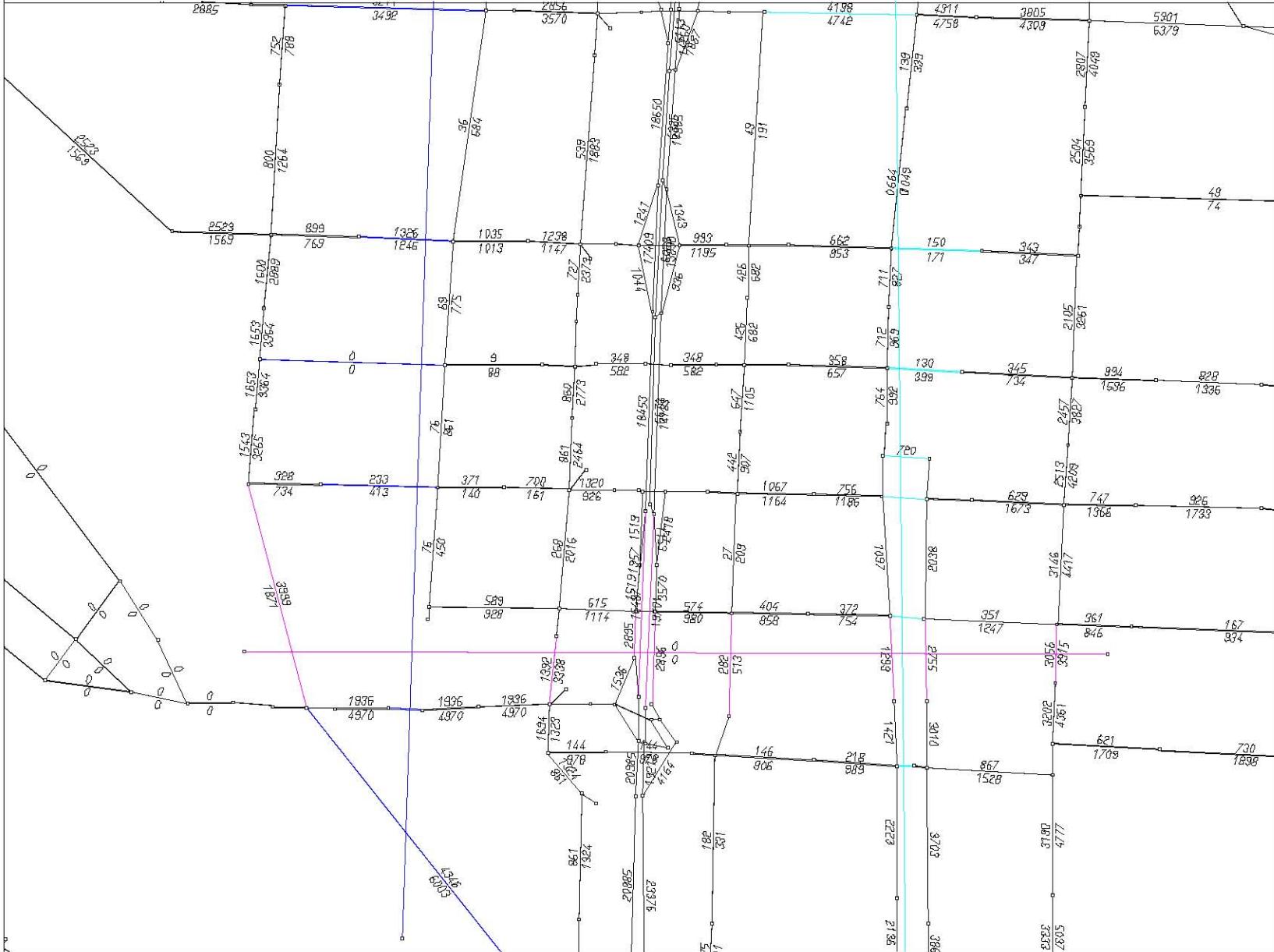

LINKS:  
 mod=c  
 mod=t  
 mod=s  
 mod=h  
 &!i=1,1260  
 &!j=1,1260  
 COL-IND:UL1  
 THRESHOLD:  
 LOWER: -99999  
 UPPER: 99999

WINDOW:  
 1446.4/131.389  
 1449/133.366

EMME/2 PROJECT: I-5 Trade Corridor Phase II Modeling  
 SCENARIO 7520: copy of sc7507 for link color codes  
 ATTRIB. @totvl: total vol (svol+hvol+(htrkp+mtrkp)/1.7)

>>

02-03-23 15:11  
 MODULE: 2.13  
 DKS2000....rjs

# BASE NETWORK

ATTRIB. @TOTVL: TOTAL VOL (SVOL+HVOL+(HTRKP+MTRKP)/1.7)

emme/2

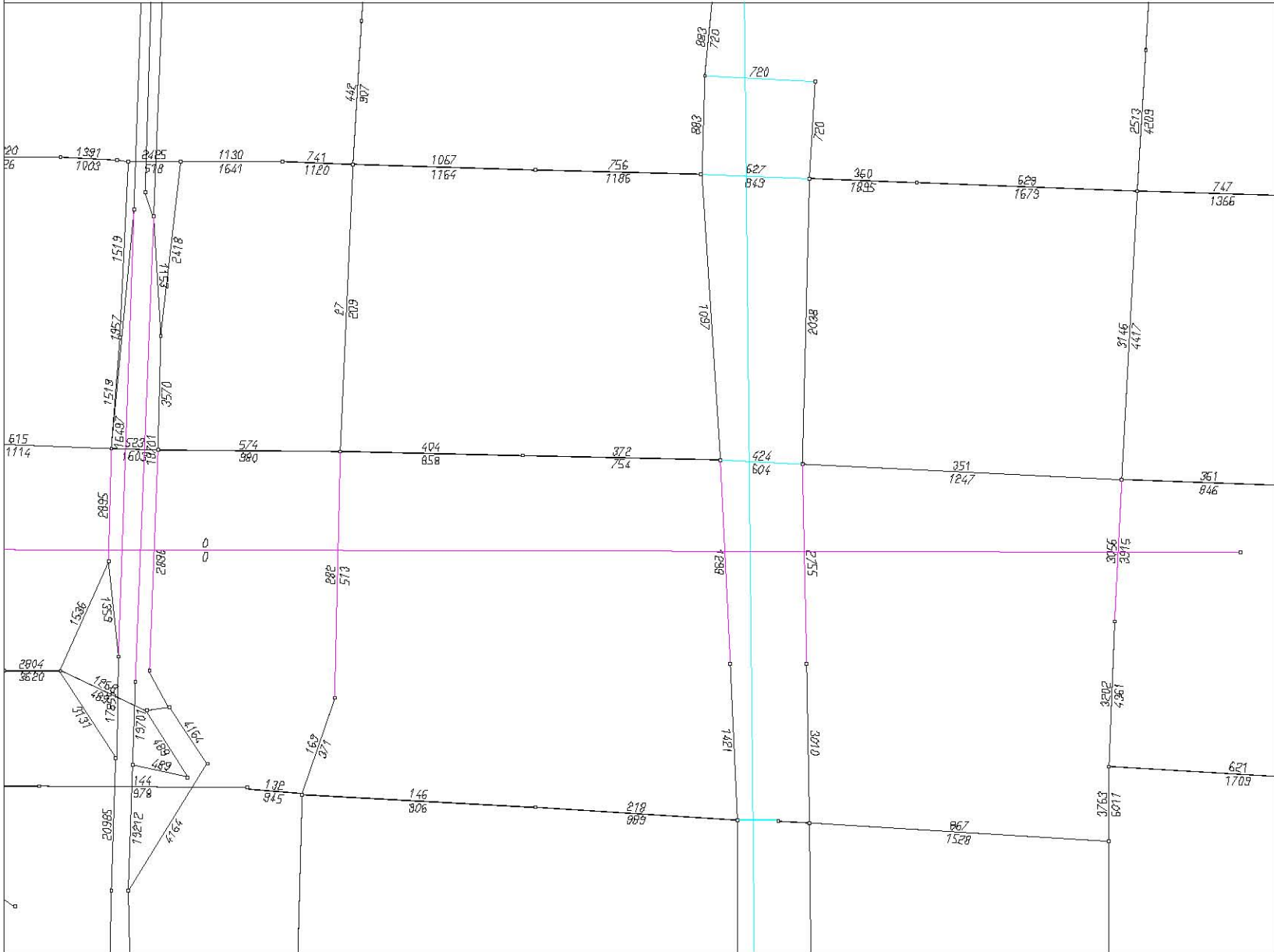

LINKS:

```

mod=c
mod=t
mod=s
mod=h
&!i=1,1260
&!j=1,1260
    
```

COL-IND:UL1

THRESHOLD:  
 LOWER: -99999  
 UPPER: 99999

WINDOW:  
 1447.6/131.662  
 1448.7/132.486

EMME/2 PROJECT: I-5 Trade Corridor Phase II Modeling  
 SCENARIO 7520: copy of sc7507 for link color codes  
 ATTRIB. @totvl: total vol (svol+hvol+(htrkp+mtrkp)/1.7)

>>

02-03-23 15:12  
 MODULE: 2.13  
 DKS2000....rjs

# BASE NETWORK

ATTRIB. @TOTVL: TOTAL VOL (SVOL+HVOL+(HTRKP+MTRKP)/1.7)

emme/2

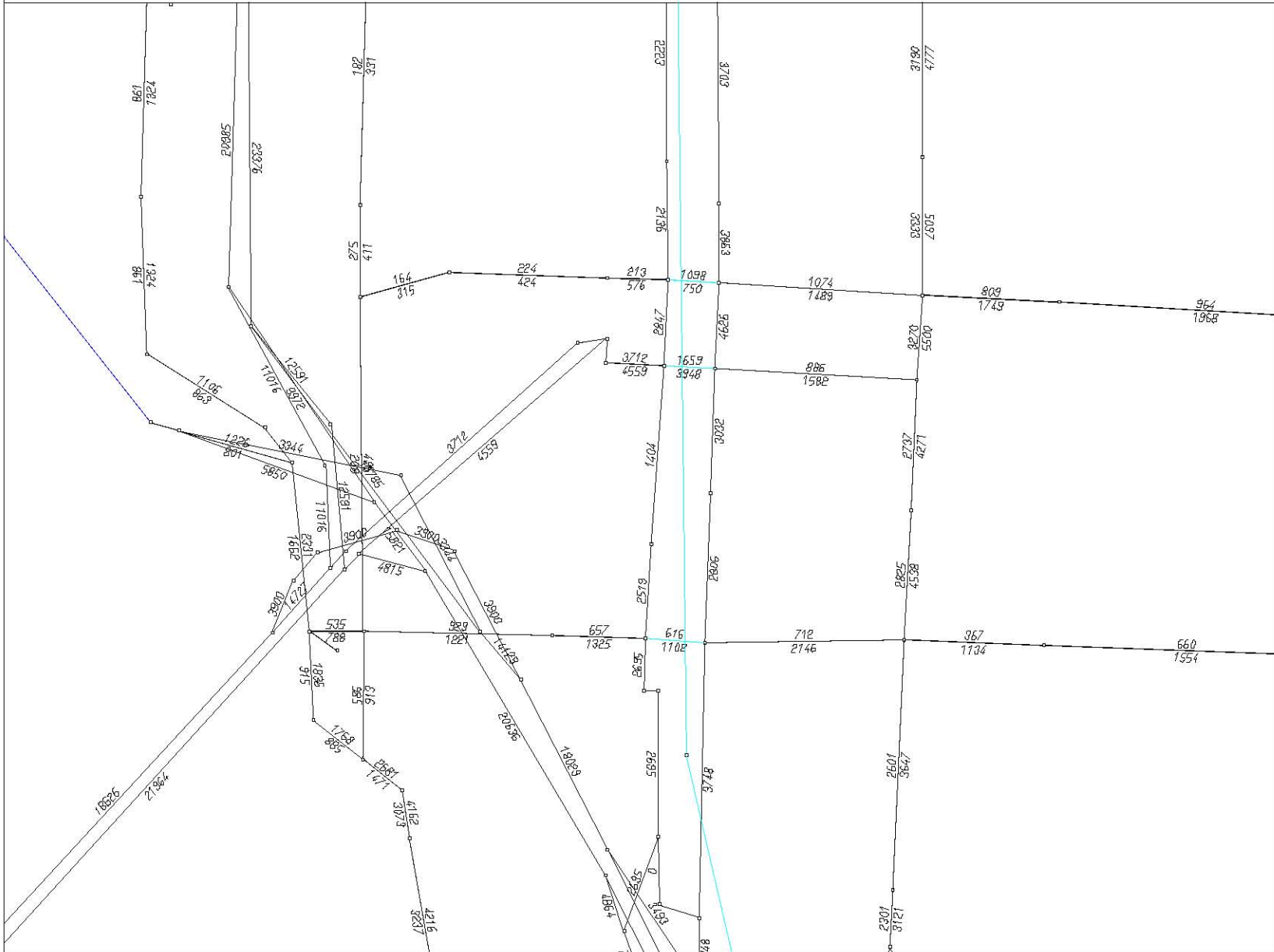

**LINKS:**

mod=c  
 mod=t  
 mod=s  
 mod=h  
 &!i=1,1260  
 &!j=1,1260

COL-IND:UL1

**THRESHOLD:**  
 LOWER: -99999  
 UPPER: 99999

**WINDOW:**  
 1447.4/130.503  
 1449/131.703

# BASE NETWORK

ATTRIB. @TOTVL: TOTAL VOL (SVOL+HVOL+(HTRKP+MTRKP)/1.7)

emme/2

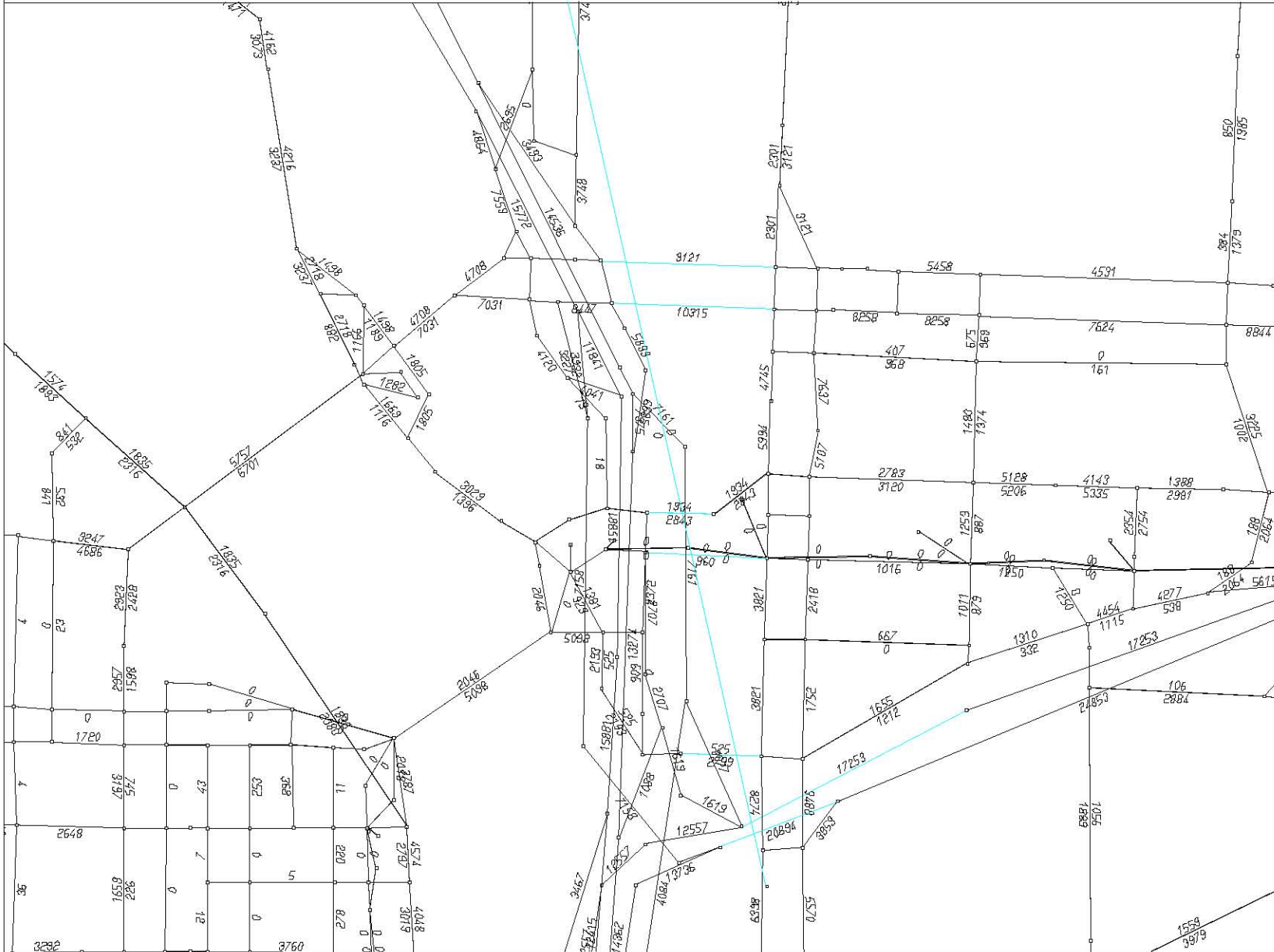

LINKS:  
mod=c  
mod=t  
mod=s  
mod=h  
&!i=1,1260  
&!j=1,1260  
COL-IND:UL1  
THRESHOLD:  
LOWER: -99999  
UPPER: 99999

WINDOW:  
1447.6/129.603  
1449.1/130.728

EMME/2 PROJECT: I-5 Trade Corridor Phase II Modeling  
SCENARIO 7520: copy of sc7507 for link color codes  
ATTRIB. @totvl: total vol (svol+hvol+(htrkp+mtrkp)/1.7)

>>

02-03-23 15:13  
MODULE: 2.13  
DKS2000....rjs