

BASE NETWORK

emme/2



LINKS:
mod=c
| mod=t
| mod=s
| mod=h
&!i=1,1260
&!j=1,1260
COL-IND:UL1

WINDOW:
1445.3/135.899
1452.9/141.598

EMME/2 PROJECT: I-5 Trade Corridor Option3c New Assignments
SCENARIO 6105: copy of sc6104 for link color codes

>>

02-03-23 15:41
MODULE: 2.13
DKS2000....rjs

BASE NETWORK

emme/2



LINKS:
mod=c
| mod=t
| mod=s
| mod=h
&!i=1,1260
&!j=1,1260
COL-IND:UL1

WINDOW:
1443.7/129.069
1453.3/136.273

EMME/2 PROJECT: I-5 Trade Corridor Option3c New Assignments
SCENARIO 6105: copy of sc6104 for link color codes

>>

02-03-23 15:42
MODULE: 2.13
DKS2000....rjs

BASE NETWORK

ATTRIB. @TOTVL: TOTAL VOL (SVOL+HVOL+(HTRKP+MTRKP)/1.7)

emme/2

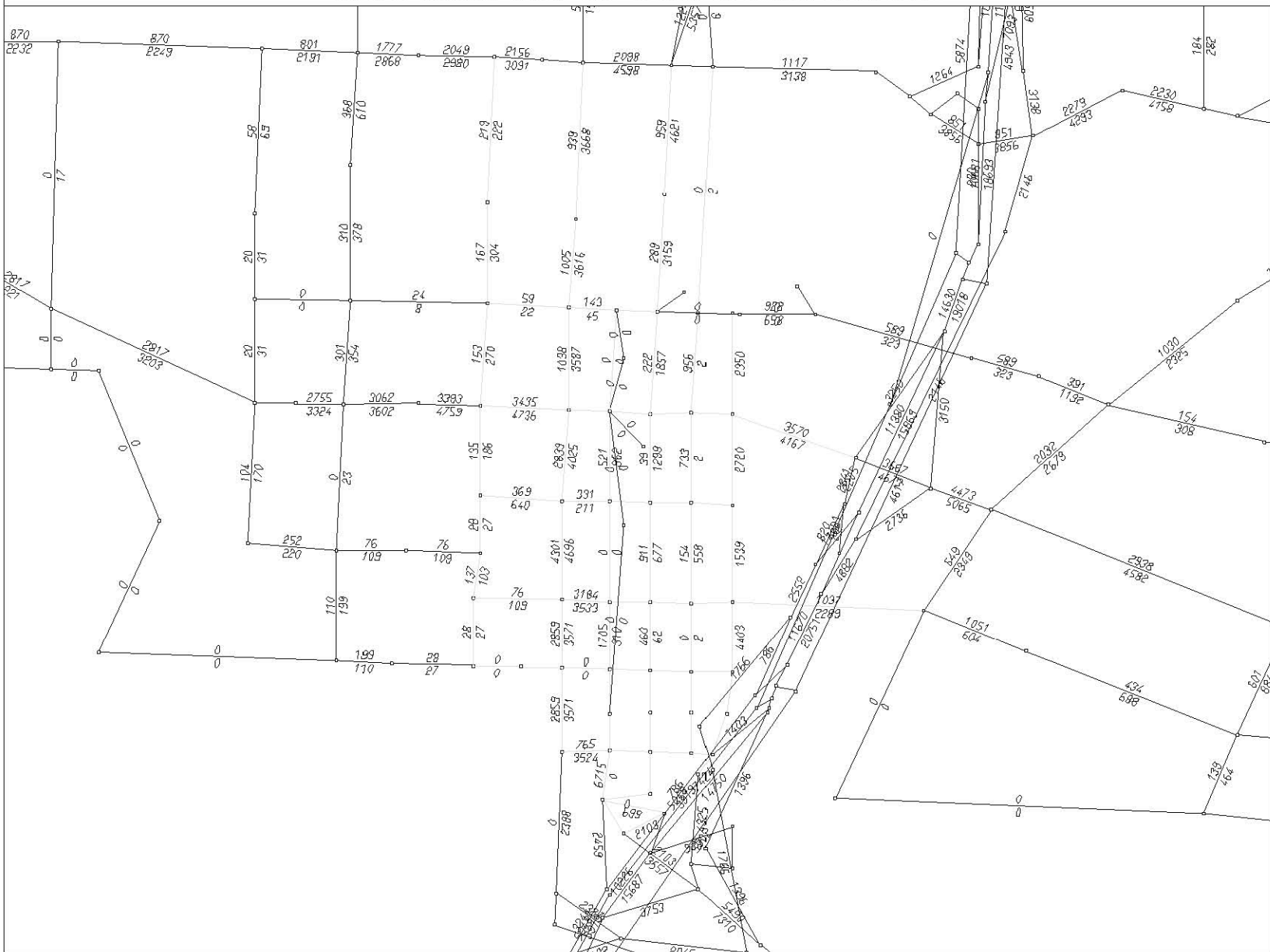

LINKS:
| mod=c
| mod=t
| mod=s
| mod=h
&!i=1,1260
&!j=1,1260
COL-IND:UL1
THRESHOLD:
LOWER: -99999
UPPER: 99999

WINDOW:
1447.3/136.371
1449.1/137.764

BASE NETWORK

ATTRIB. @TOTVL: TOTAL VOL (SVOL+HVOL+(HTRKP+MTRKP)/1.7)

emme/2

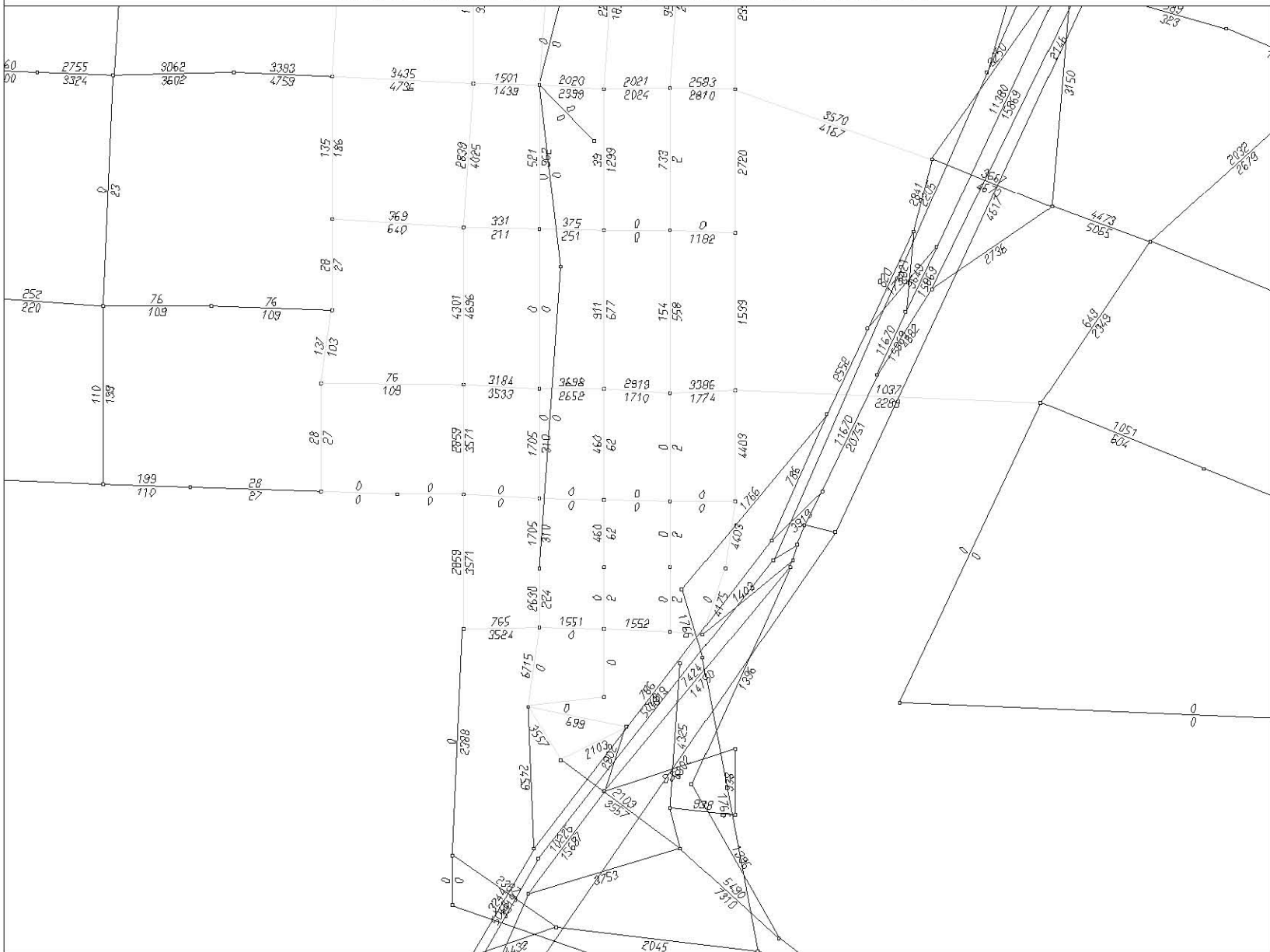

LINKS:
 mod=c
 | mod=t
 | mod=s
 | mod=h
 &!i=1,1260
 &!j=1,1260

COL-IND:UL1

THRESHOLD:
 LOWER: -99999
 UPPER: 99999

WINDOW:
 1447.7/136.369
 1448.8/ 137.24

EMME/2 PROJECT: I-5 Trade Corridor Option3c New Assignments
 SCENARIO 6105: copy of sc6104 for link color codes
 ATTRIB. @totvl: total vol (svol+hvol+(htrkp+mtrkp)/1.7)

>>

02-03-23 15:29
 MODULE: r.13
 DKS2000....rjs

BASE NETWORK

ATTRIB. @TOTVL: TOTAL VOL (SVOL+HVOL+(HTRKP+MTRKP)/1.7)

emme/2

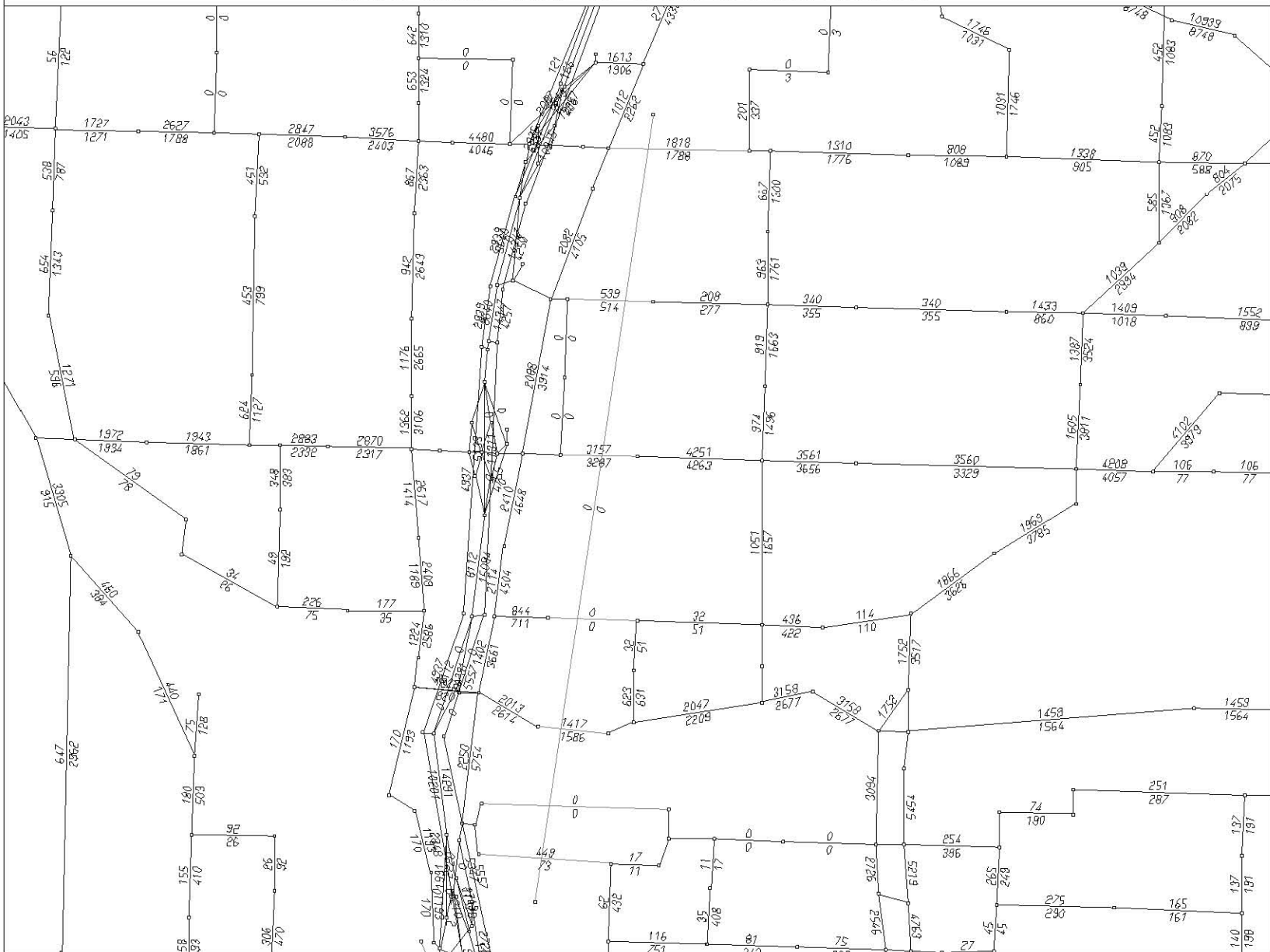

LINKS:
 mod=c
 | mod=t
 | mod=s
 | mod=h
 &!i=1,1260
 &!j=1,1260

COL-IND:UL1

THRESHOLD:
 LOWER: -99999
 UPPER: 99999

WINDOW:
 1447.2/138.763
 1451.1/ 141.75

EMME/2 PROJECT: I-5 Trade Corridor Option3c New Assignments
 SCENARIO 6105: copy of sc6104 for link color codes
 ATTRIB. @totvl: total vol (svol+hvol+(htrkp+mtrkp)/1.7)

>>

02-03-23 15:42
 MODULE: 2.13
 DKS2000....rjs

BASE NETWORK

ATTRIB. @TOTVL: TOTAL VOL (SVOL+HVOL+(HTRKP+MTRKP)/1.7)

emme/2

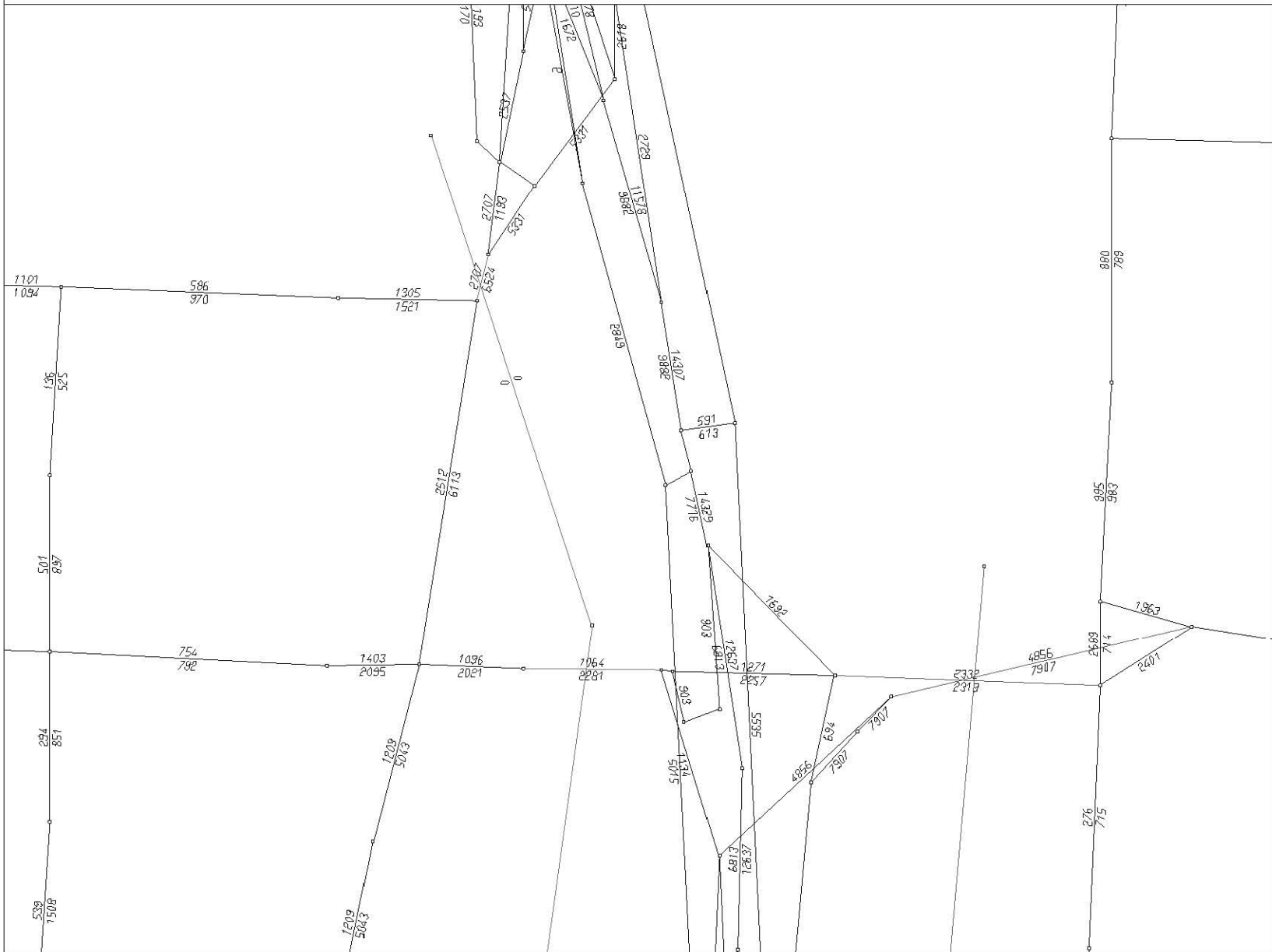

LINKS:
mod=c
| mod=t
| mod=s
| mod=h
&!i=1,1260
&!j=1,1260

COL-IND:UL1

THRESHOLD:
LOWER: -99999
UPPER: 99999

WINDOW:
1448.1/ 138.09
1449.2/138.915

EMME/2 PROJECT: I-5 Trade Corridor Option3c New Assignments
SCENARIO 6105: copy of sc6104 for link color codes
ATTRIB. @totvl: total vol (svol+hvol+(htrkp+mtrkp)/1.7)

>>

02-03-23 15:43
MODULE: 2.13
DKS2000....rjs

BASE NETWORK

ATTRIB. @TOTVL: TOTAL VOL (SVOL+HVOL+(HTRKP+MTRKP)/1.7)

emme/2

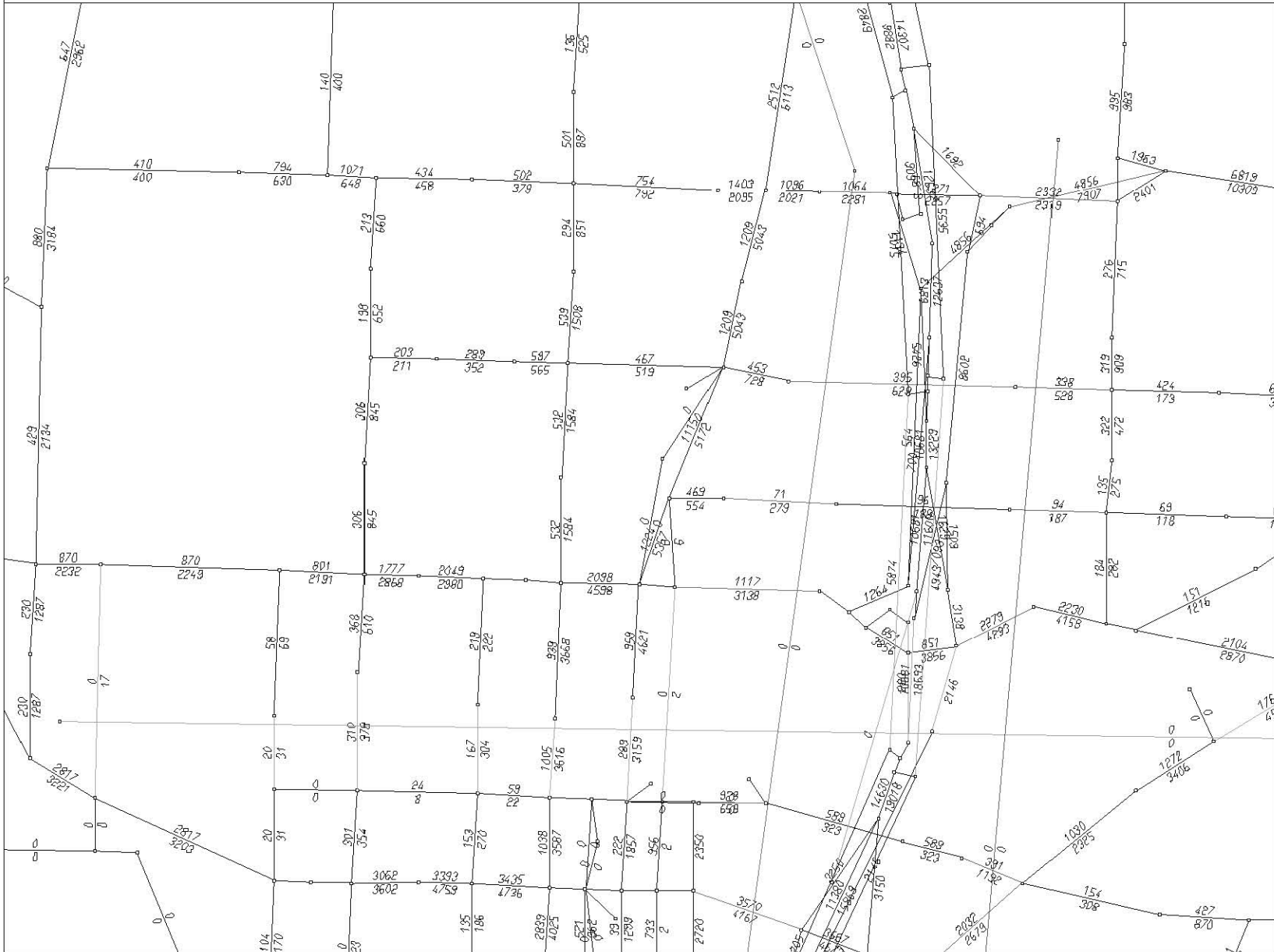

LINKS:
 mod=c
 | mod=t
 | mod=s
 | mod=h
 &!i=1,1260
 &!j=1,1260
COL-IND:UL1
THRESHOLD:
 LOWER: -99999
 UPPER: 99999

WINDOW:
 1447.2/ 137.06
 1449.3/138.654
 02-03-23 15:44
 MODULE: 2.13
 DKS2000....rjs

EMME/2 PROJECT: I-5 Trade Corridor Option3c New Assignments
 SCENARIO 6105: copy of sc6104 for link color codes
 ATTRIB. @totvl: total vol (svol+hvol+(htrkp+mtrkp)/1.7)

>>

BASE NETWORK

ATTRIB. @TOTVL: TOTAL VOL (SVOL+HVOL+(HTRKP+MTRKP)/1.7)

emme/2

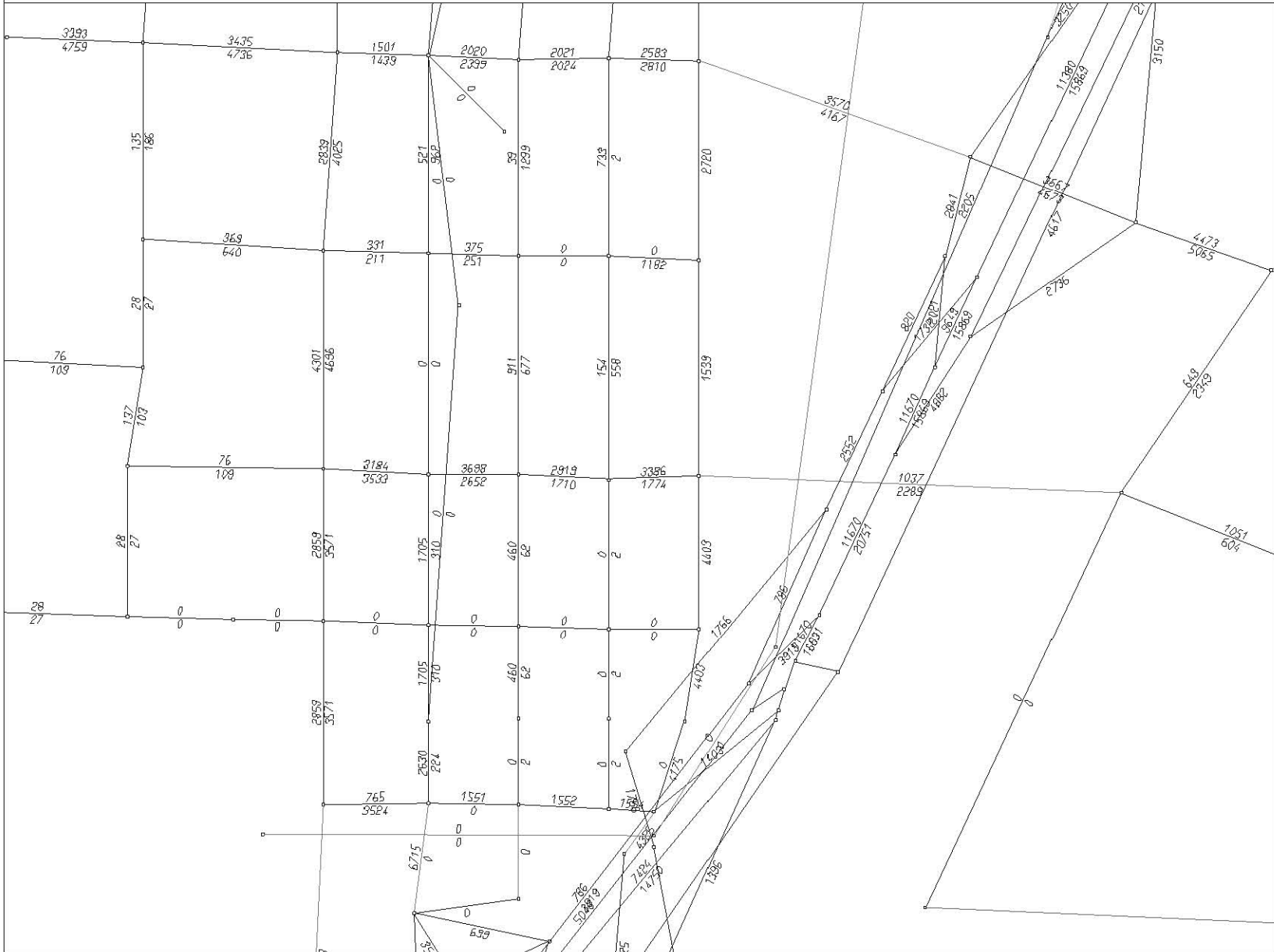

LINKS:
 mod=c
 | mod=t
 | mod=s
 | mod=h
 &!i=1,1260
 &!j=1,1260

COL-IND:UL1

THRESHOLD:
 LOWER: -99999
 UPPER: 99999

WINDOW:
 1447.9/136.569
 1448.7/137.202

EMME/2 PROJECT: I-5 Trade Corridor Option3c New Assignments
 SCENARIO 6105: copy of sc6104 for link color codes
 ATTRIB. @totvl: total vol (svol+hvol+(htrkp+mtrkp)/1.7)

>>

02-03-23 15:45
 MODULE: 2.13
 DKS2000....rjs

BASE NETWORK

ATTRIB. @TOTVL: TOTAL VOL (SVOL+HVOL+(HTRKP+MTRKP)/1.7)

emme/2

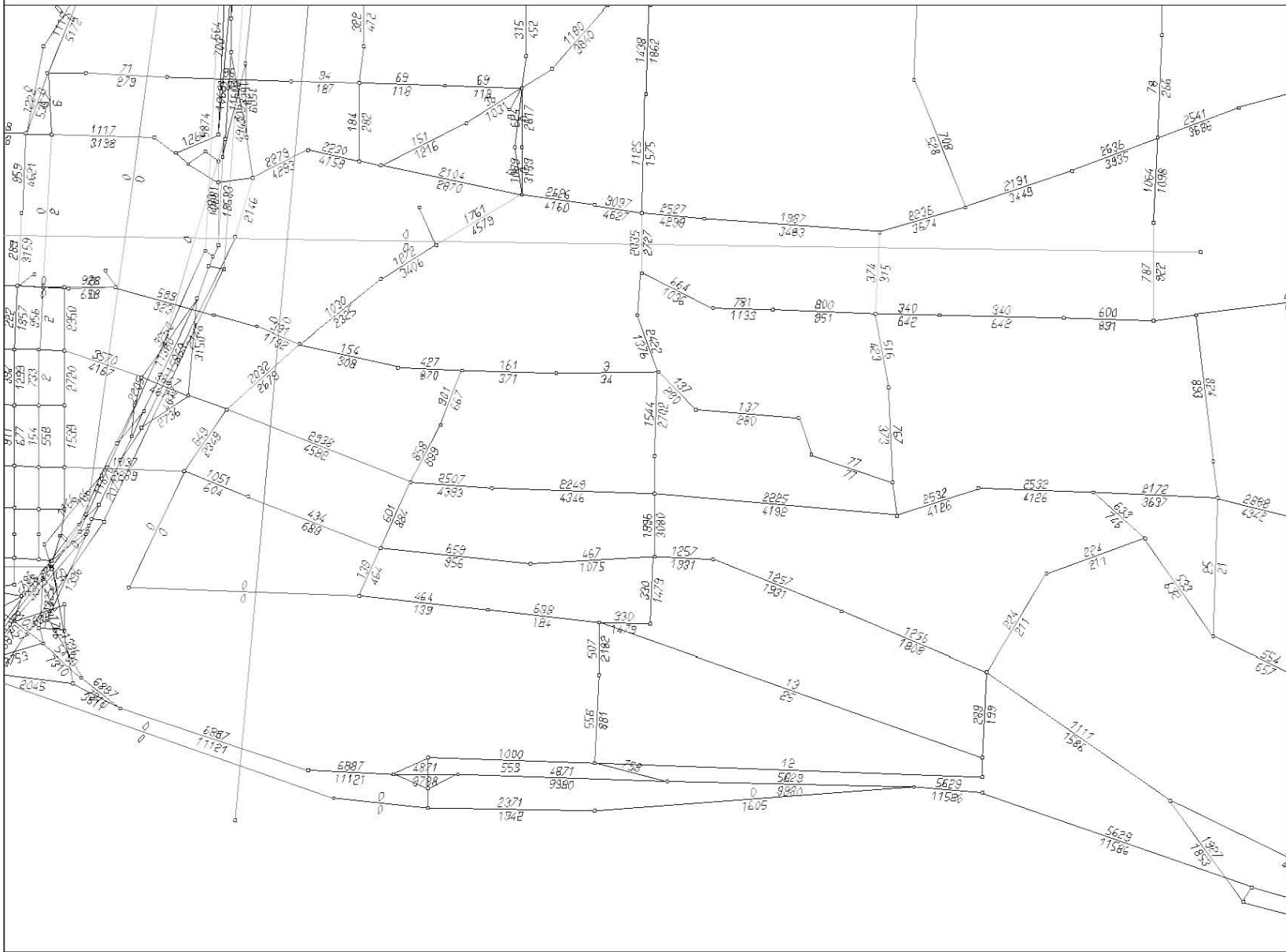

LINKS:
| mod=c
| mod=t
| mod=s
| mod=h
&i=1,1260
&j=1,1260
COL-IND:UL1
THRESHOLD:
LOWER: -99999
UPPER: 99999

WINDOW:
1448.2/135.728
1451.2/137.983

EMME/2 PROJECT: I-5 Trade Corridor Option3c New Assignments
SCENARIO 6105: copy of sc6104 for link color codes
ATTRIB. @totvl: total vol (svol+hvol+(htrkp+mtrkp)/1.7)

>>

02-03-23 15:45
MODULE: 2.13
DKS2000....rjs

BASE NETWORK

ATTRIB. @TOTVL: TOTAL VOL (SVOL+HVOL+(HTRKP+MTRKP)/1.7)

emme/2

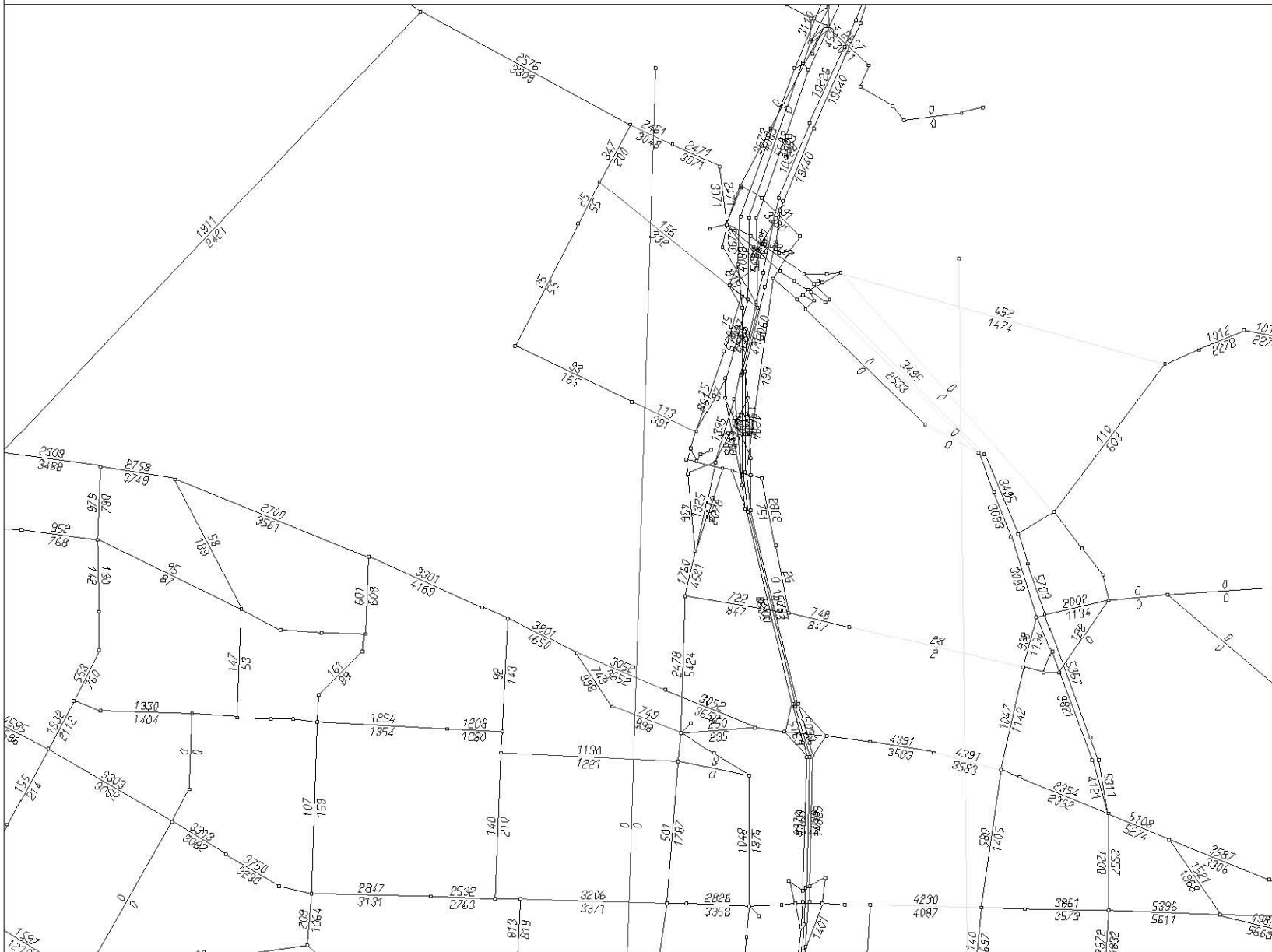

LINKS:

mod=c
| mod=t
| mod=s
| mod=h
&!i=1,1260
&!j=1,1260

COL-IND:UL1

THRESHOLD:
LOWER: -99999
UPPER: 99999

WINDOW:

1445.5/133.209
1449.1/135.908

EMME/2 PROJECT: I-5 Trade Corridor Option3c New Assignments
SCENARIO 6105: copy of sc6104 for link color codes
ATTRIB. @totvl: total vol (svol+hvol+(htrkp+mtrkp)/1.7)

>>

02-03-23 15:46
MODULE: 2.13
DKS2000....rjs

BASE NETWORK

ATTRIB. @TOTVL: TOTAL VOL (SVOL+HVOL+(HTRKP+MTRKP)/1.7)

emme/2

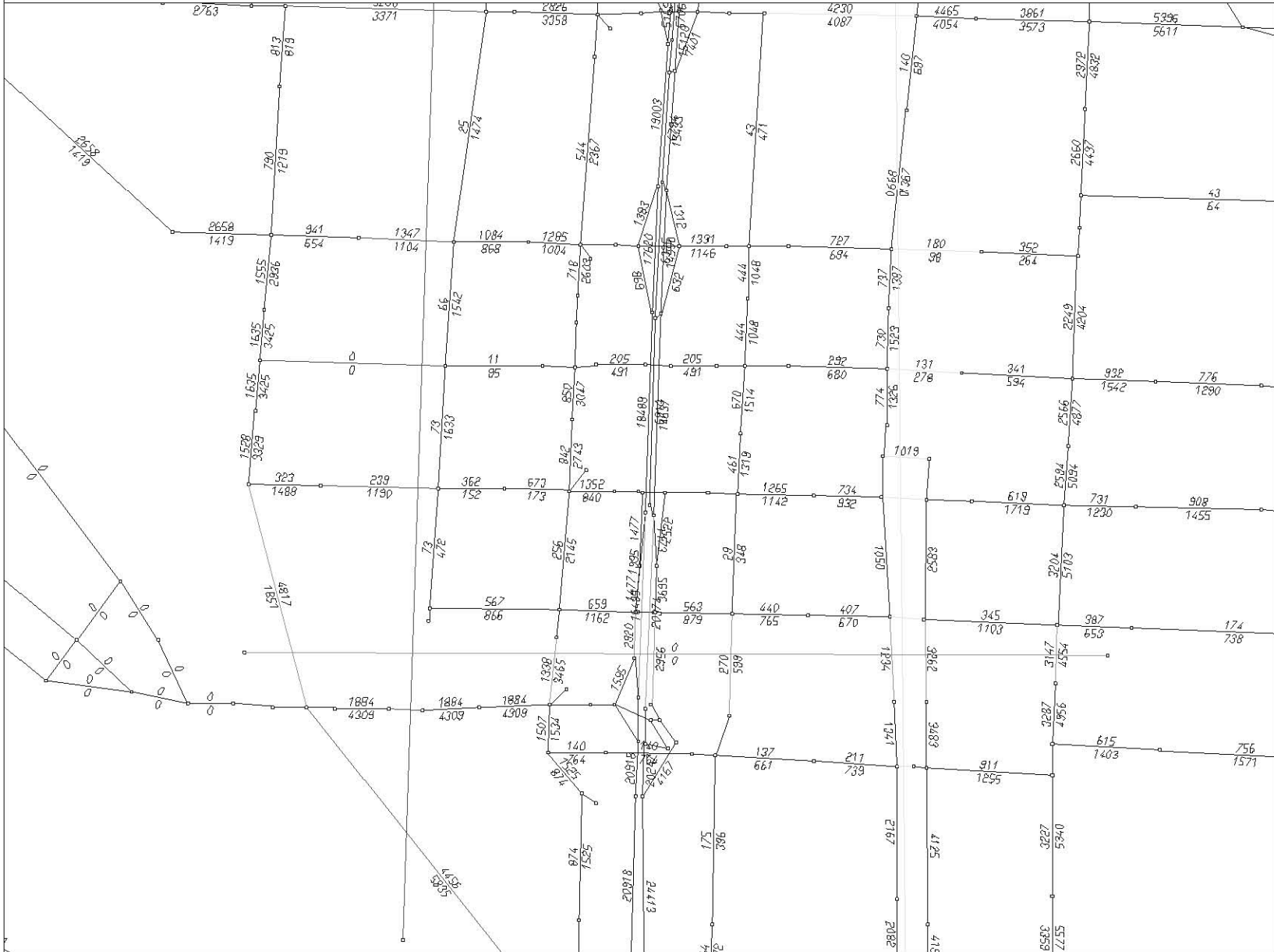

LINKS:
 mod=c
 | mod=t
 | mod=s
 | mod=h
 &!i=1,1260
 &!j=1,1260

COL-IND:UL1

THRESHOLD:
 LOWER: -99999
 UPPER: 99999

WINDOW:
 1446.4/131.389
 1449/133.366

EMME/2 PROJECT: I-5 Trade Corridor Option3c New Assignments
 SCENARIO 6105: copy of sc6104 for link color codes
 ATTRIB. @totvl: total vol (svol+hvol+(htrkp+mtrkp)/1.7)

>>

02-03-23 15:47
 MODULE: 2.13
 DKS2000....rjs

BASE NETWORK

ATTRIB. @TOTVL: TOTAL VOL (SVOL+HVOL+(HTRKP+MTRKP)/1.7)

emme/2

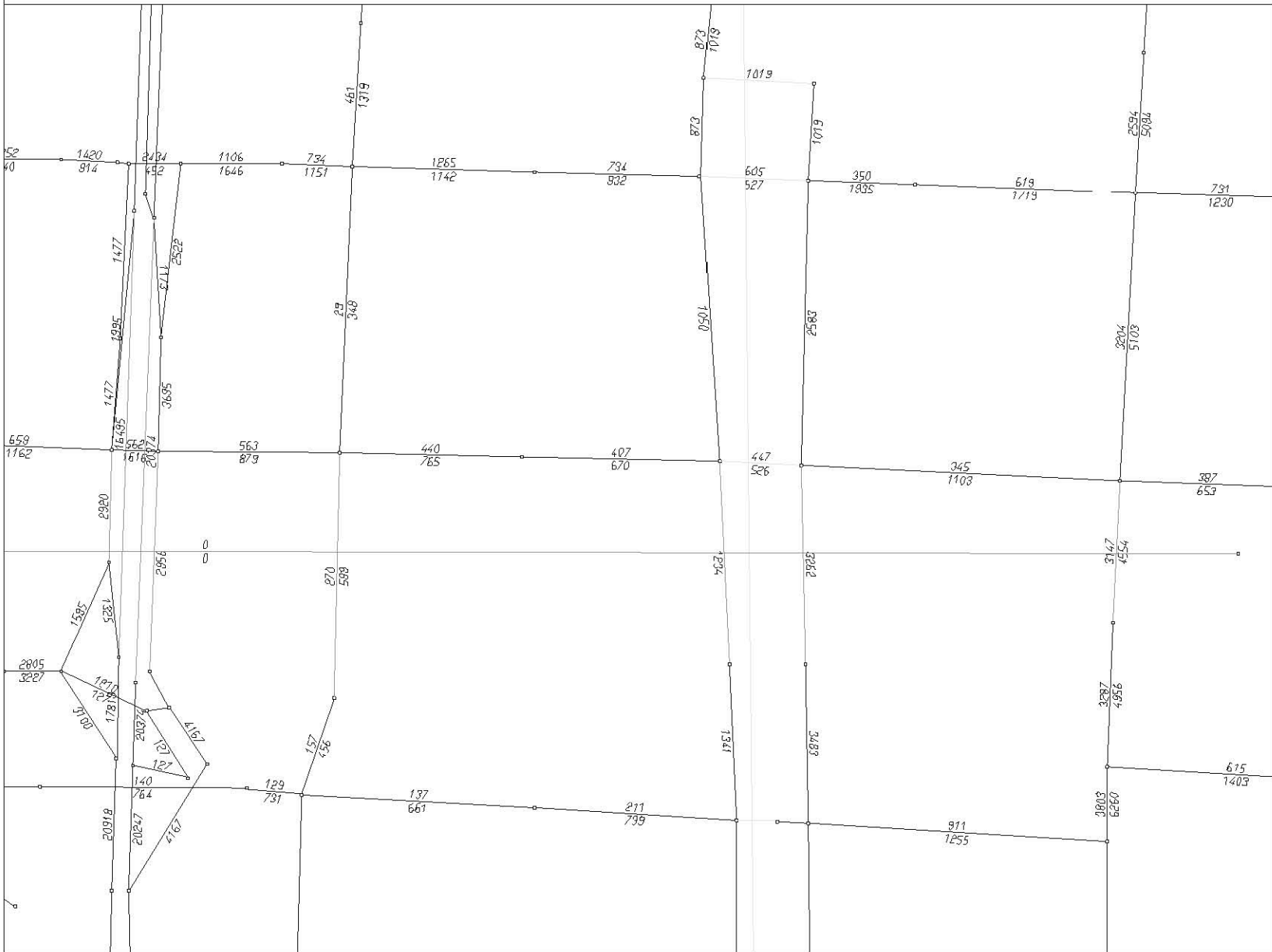

LINKS:

mod=c
| mod=t
| mod=s
| mod=h
&!i=1,1260
&!j=1,1260

COL-IND:UL1

THRESHOLD:
LOWER: -99999
UPPER: 99999

WINDOW:

1447.6/131.662
1448.7/132.486

EMME/2 PROJECT: I-5 Trade Corridor Option3c New Assignments
SCENARIO 6105: copy of sc6104 for link color codes
ATTRIB. @totvl: total vol (svol+hvol+(htrkp+mtrkp)/1.7)

>>

02-03-23 15:47
MODULE: 2.13
DKS2000....rjs

BASE NETWORK

ATTRIB. @TOTVL: TOTAL VOL (SVOL+HVOL+(HTRKP+MTRKP)/1.7)

emme/2

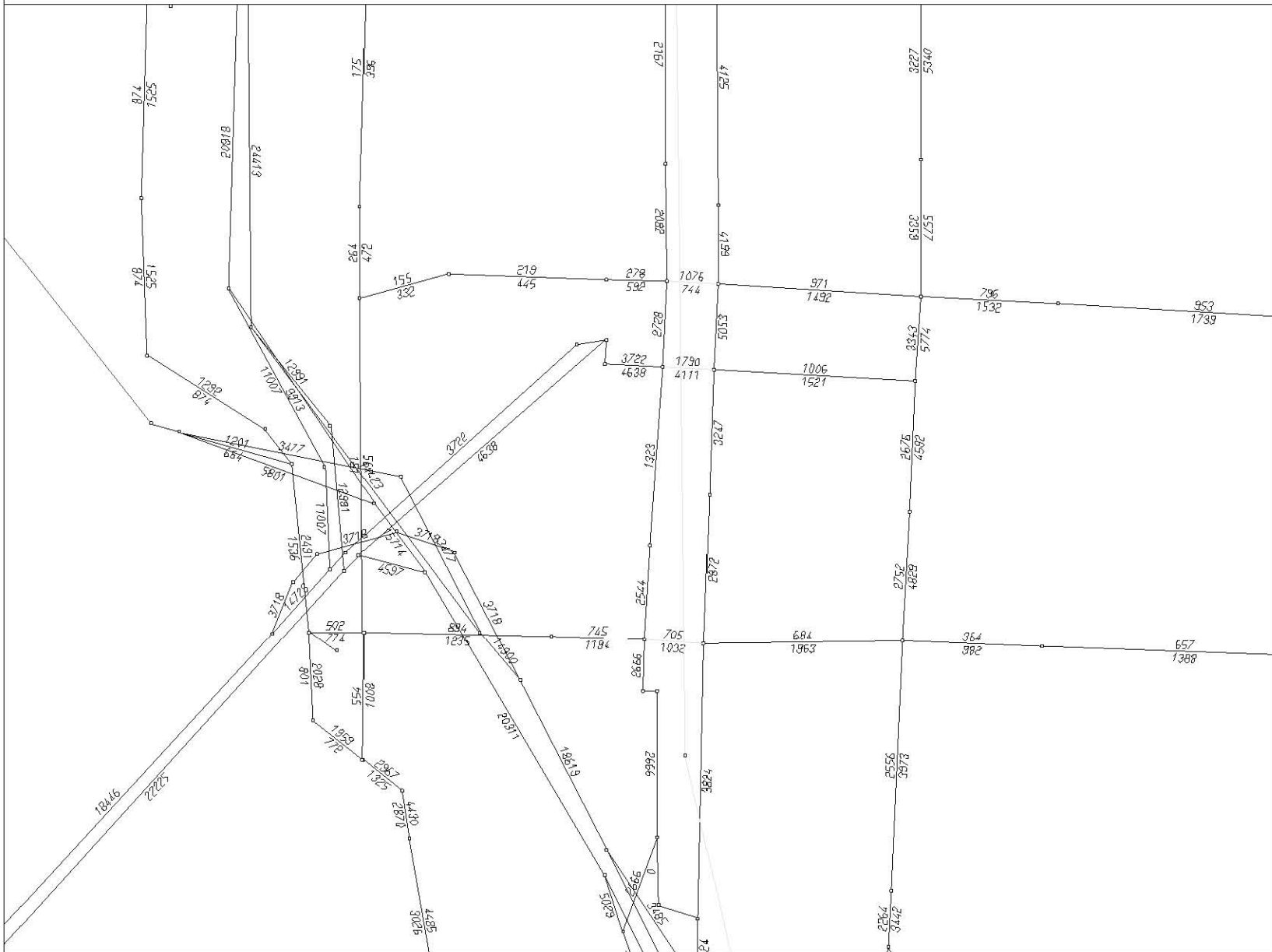

LINKS:
mod=c
| mod=t
| mod=s
| mod=h
&!i=1,1260
&!j=1,1260
COL-IND:UL1
THRESHOLD:
LOWER: -99999
UPPER: 99999

WINDOW:
1447.4/130.503
1449/131.703

EMME/2 PROJECT: I-5 Trade Corridor Option3c New Assignments
SCENARIO 6105: copy of sc6104 for link color codes
ATTRIB. @totvl: total vol (svol+hvol+(htrkp+mtrkp)/1.7)

>>

02-03-23 15:48
MODULE: 2.13
DKS2000....rjs

BASE NETWORK

ATTRIB. @TOTVL: TOTAL VOL (SVOL+HVOL+(HTRKP+MTRKP)/1.7)

emme/2

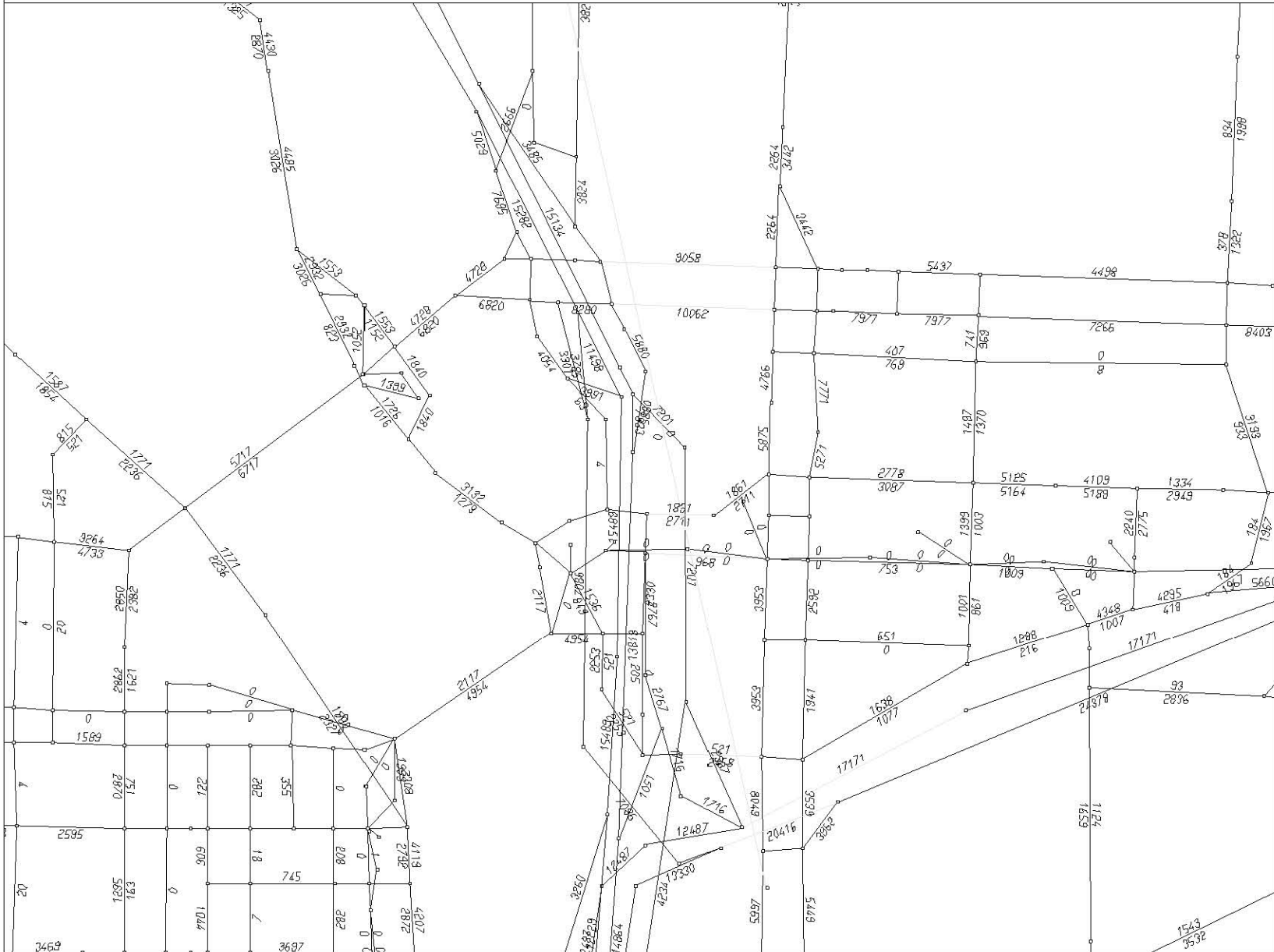

LINKS:
 mod=c
 | mod=t
 | mod=s
 | mod=h
 &!i=1,1260
 &!j=1,1260

COL-IND:UL1

THRESHOLD:
 LOWER: -99999
 UPPER: 99999

WINDOW:
 1447.6/129.603
 1449.1/130.728

EMME/2 PROJECT: I-5 Trade Corridor Option3c New Assignments
 SCENARIO 6105: copy of sc6104 for link color codes
 ATTRIB. @totvl: total vol (svol+hvol+(htrkp+mtrkp)/1.7)

>>

02-03-23 15:48
 MODULE: 2.13
 DKS2000....rjs