

Rog

66.7

# Traffic Noise Monitoring Information Sheet

Project Name: Columbia River Crossing

Monitoring Location: Big Tree S. side Site Number: \_\_\_\_\_

Date: 7/3 Start Time Hwy 14 RR overpass  
15:53:33 Leq 65.9

Weather Conditions: S

### Traffic Counts:

Roadway Name: \_\_\_\_\_ Cars \_\_\_\_\_ MedTrucks \_\_\_\_\_ HvyTrucks \_\_\_\_\_

Roadway Name: \_\_\_\_\_ Cars \_\_\_\_\_ MedTrucks \_\_\_\_\_ HvyTrucks \_\_\_\_\_

Area Observations: \_\_\_\_\_

Train - slow moving

occ. Air traffic, construction tractor.

### SiteSketch

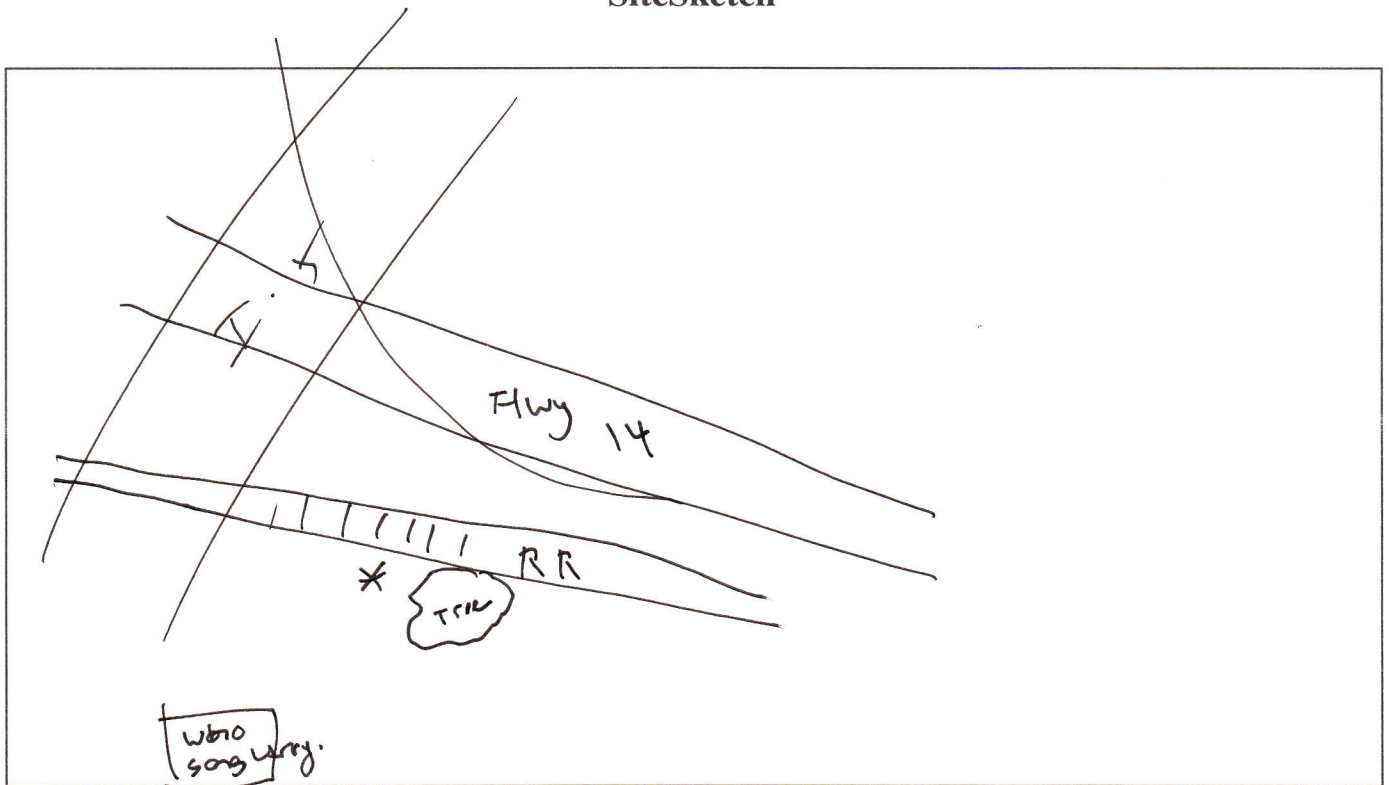

661, 660, 659, 658 - Apple tree sign.

65.5

### Traffic Noise Monitoring Information Sheet

Project Name: Columbia River Crossing

Monitoring Location: Hwy 14 West to I-5 N. <sup>on ramp</sup> Site Number: \_\_\_\_\_

Date: 7/3/07 Start Time 15:28:08 Leq 63.1  
Orange

Weather Conditions: S.

#### Traffic Counts:

Roadway Name: \_\_\_\_\_ Cars \_\_\_\_\_ MedTrucks \_\_\_\_\_ HvyTrucks \_\_\_\_\_

Roadway Name: \_\_\_\_\_ Cars \_\_\_\_\_ MedTrucks \_\_\_\_\_ HvyTrucks \_\_\_\_\_

Area Observations: Occ. Air traffic  
GPS. N45°:37'20" E W 122°40'6"

#### SiteSketch

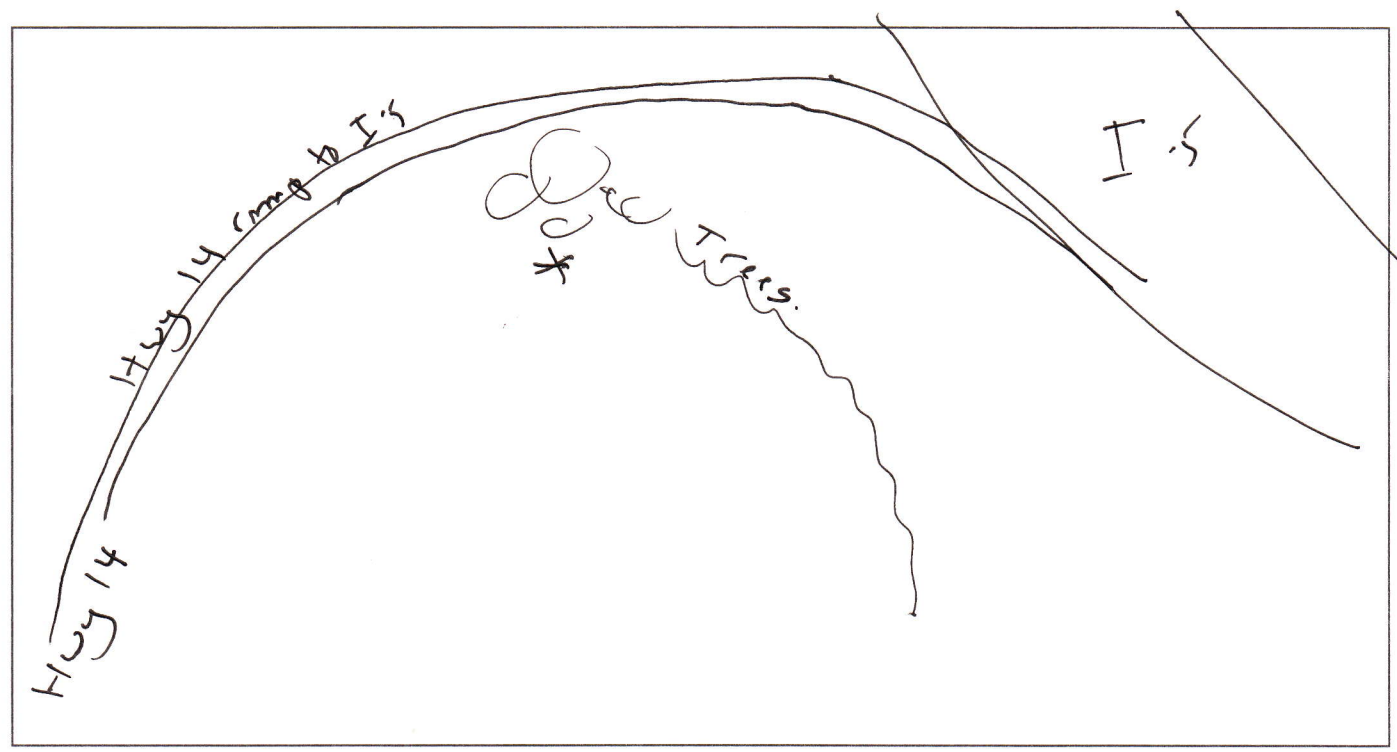

Pics ~~to 66, 667, 668~~  
664, 663, 662

69.4

Traffic Noise Monitoring Information Sheet

Project Name: Columbia River Crossing ~~610 5th St~~

Monitoring Location: FHWA 610 E. 5th St. Site Number: ①

Date: 7/3 Start Time 13:37:45 Leq 67.9  
and 13:52:45

Weather Conditions: S.

Traffic Counts:

Roadway Name: I-5 Cars \_\_\_\_\_ MedTrucks \_\_\_\_\_ HvyTrucks \_\_\_\_\_

Roadway Name: \_\_\_\_\_ Cars \_\_\_\_\_ MedTrucks \_\_\_\_\_ HvyTrucks \_\_\_\_\_

Area Observations: no sound well.

SiteSketch

①

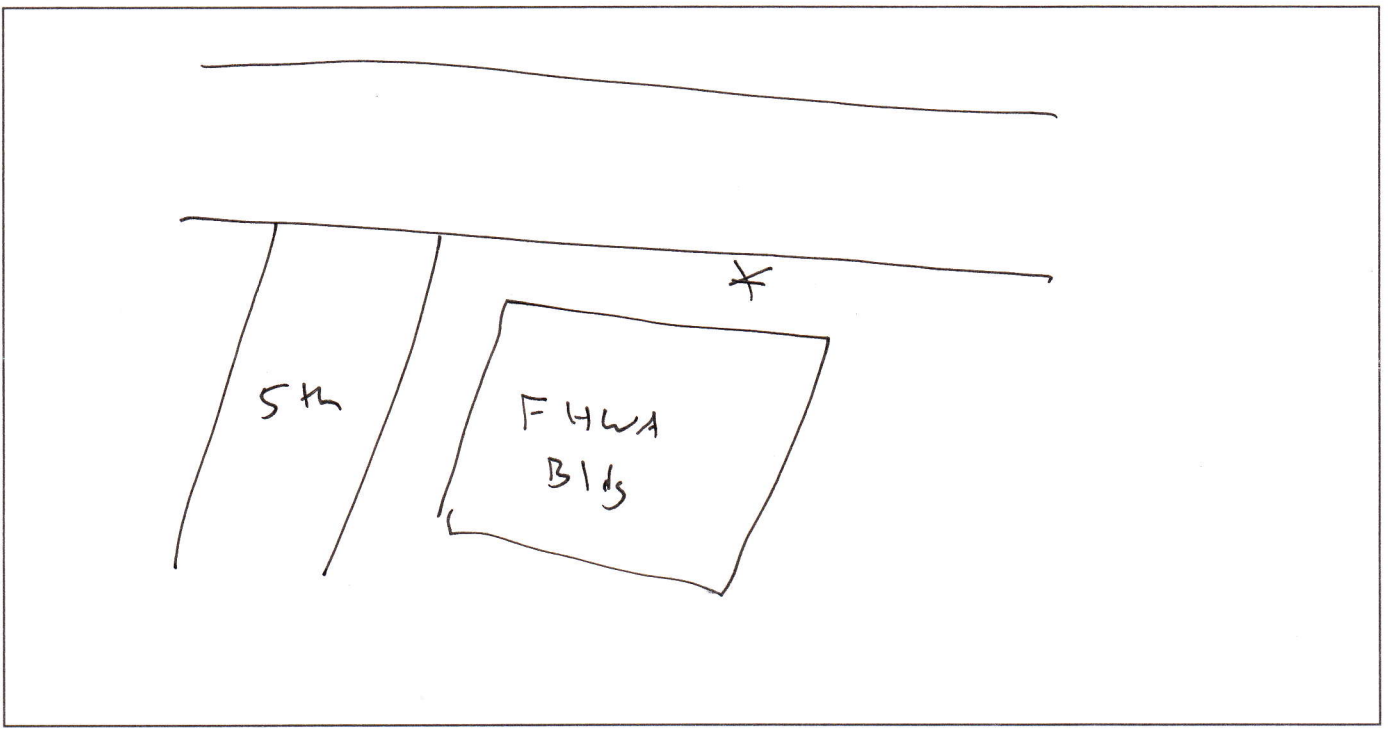

PIC 1-3

2

67.3

# Traffic Noise Monitoring Information Sheet

Meter #1  
Orange  
Project Name: Columbia River Crossing E. Hathaway Rd.

Monitoring Location: Fort Vancouver Post Hospital "411" Site Number: 2

Date: 7/13 Start Time 13:58:53 Leq 69.6  
14:13:53

Weather Conditions: S.

### Traffic Counts:

Roadway Name: I-5 Cars \_\_\_\_\_ MedTrucks \_\_\_\_\_ HvyTrucks \_\_\_\_\_

Roadway Name: \_\_\_\_\_ Cars \_\_\_\_\_ MedTrucks \_\_\_\_\_ HvyTrucks \_\_\_\_\_

Area Observations: no sound wall, partial shielding from  
six-car garage,

### Site Sketch

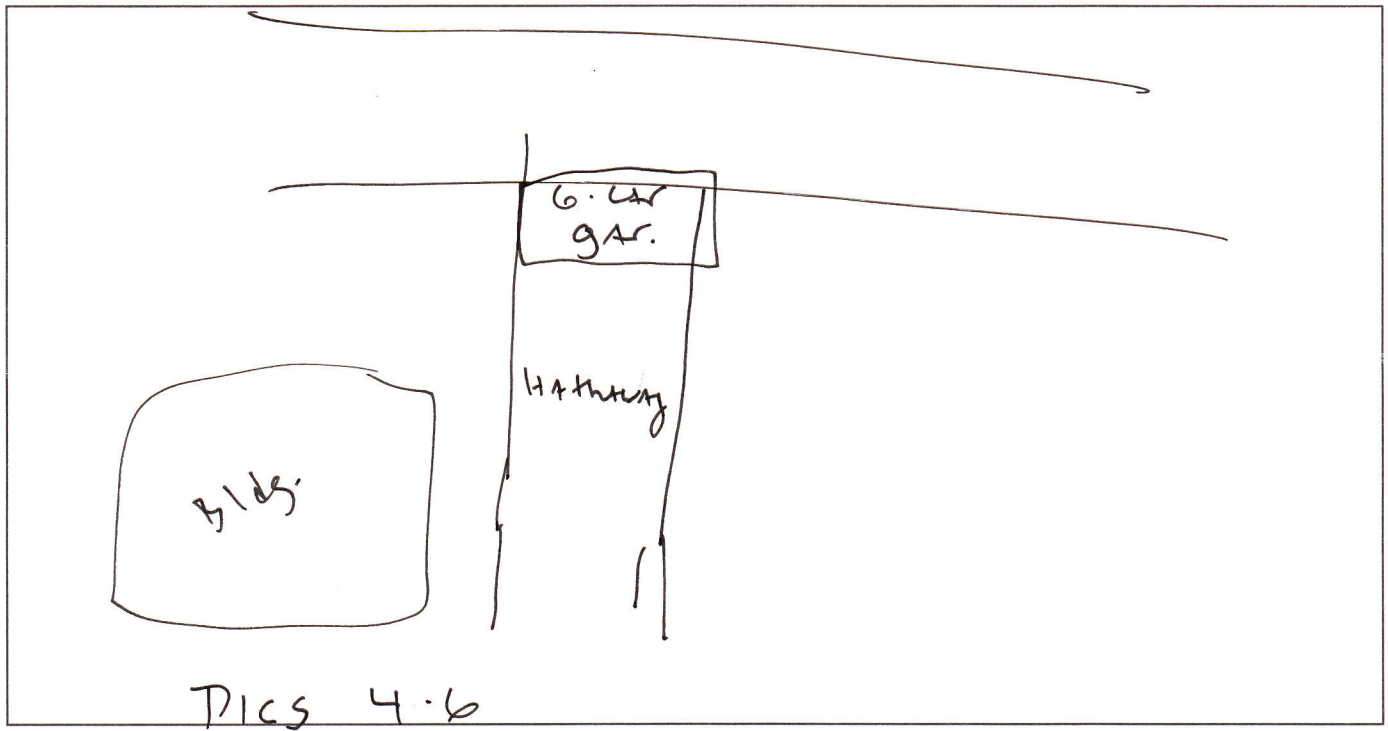

3

69.2

### Traffic Noise Monitoring Information Sheet

Fort Vanc. corner of Mc Lellan / Barnes



Purple  
Monitoring Location: ~~South Wall~~ ~~at redwood~~

Site Number: 3

Date: 7/13 Start Time 14:03:16 Leq 68.0

Weather Conditions: S

#### Local Traffic Counts:

Roadway Name: I-5 Cars \_\_\_\_\_ MedTrucks \_\_\_\_\_ HvyTrucks \_\_\_\_\_

Roadway Name: \_\_\_\_\_ Cars \_\_\_\_\_ MedTrucks \_\_\_\_\_ HvyTrucks \_\_\_\_\_

Area Observations: bf

Large bldg South side

#### SiteSketch



Pics 7-9

69.6

Traffic Noise Monitoring Information Sheet

④ Purple meter 603

Monitoring Location: Officers Row Site Number: ④

Date: 7/3/07 Start Time 14:26:18 Leq 73.3

Weather Conditions: S.

Local Traffic Counts:

Roadway Name: I-5 Cars \_\_\_\_\_ MedTrucks \_\_\_\_\_ HvyTrucks \_\_\_\_\_

Roadway Name: \_\_\_\_\_ Cars \_\_\_\_\_ MedTrucks \_\_\_\_\_ HvyTrucks \_\_\_\_\_

Area Observations: \_\_\_\_\_

Site Sketch

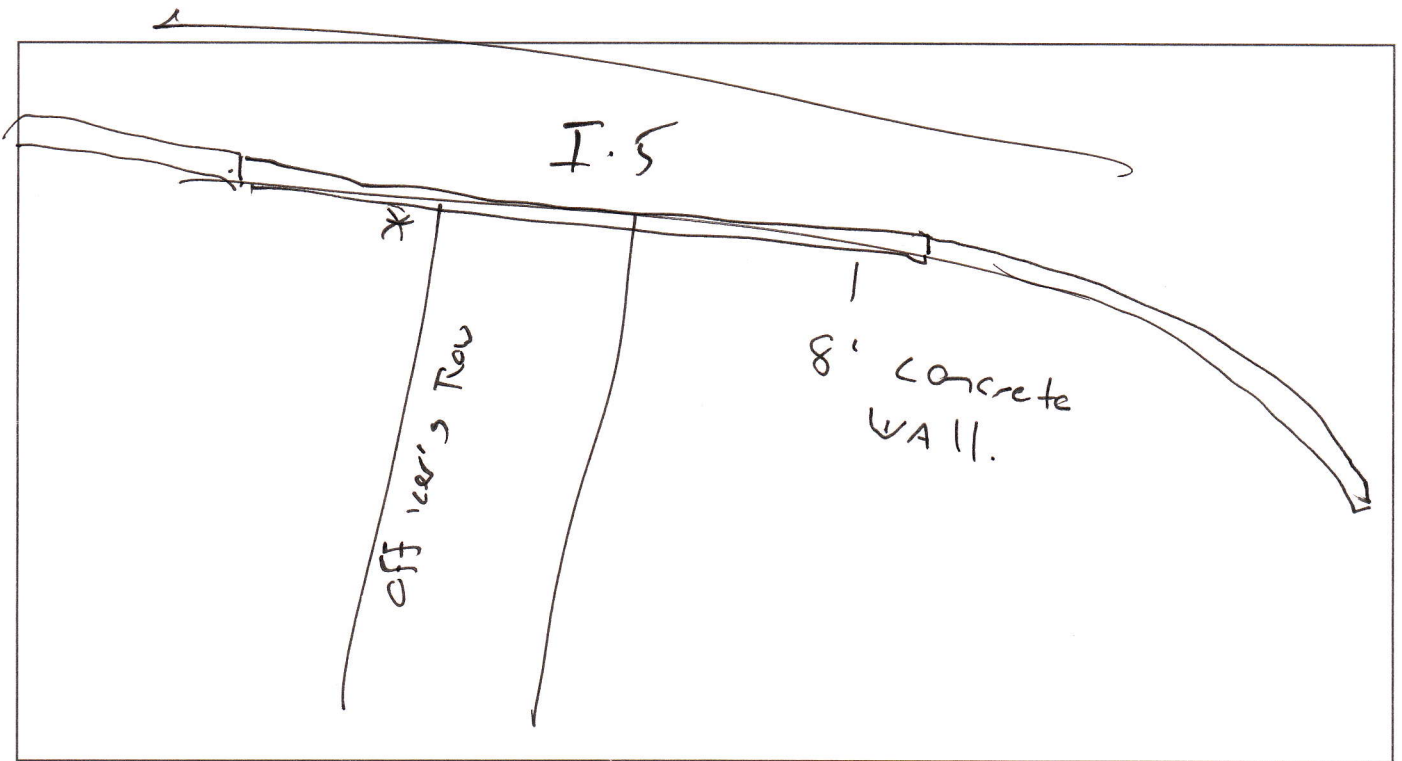

PICS 10.12