

2



Street

E 39th Street

• 3801 H ST  
E 38th Street

• 701 I ST

E 37th Street

• 3615 H ST

E 36th Street

• 811 E 36th

E 35th Street

• 3413 H ST

E 34th Street

• 901 34th

• FBA 3306 (T)

• 904 33rd (T)

E 33rd Street

et

et

et

et

et

et



73.4 / 67.4

# Traffic Noise Monitoring Information Sheet

corrected

Monitoring Location: 904 33rd Site Number: \_\_\_\_\_

Date: 6/13/07 Start Time 15:17 Leq 65.5

Weather Conditions: same

Roadway Name: 33rd Local Traffic Counts: 44 cars + on 33rd  
 Cars |||| Med Trucks 1 Hvy Trucks \_\_\_\_\_  
10 ||| ||| |||  
|||| |||

Roadway Name: \_\_\_\_\_ Cars \_\_\_\_\_ Med Trucks \_\_\_\_\_ Hvy Trucks \_\_\_\_\_

Area Observations: DOGS BARK 2 ft from meter about 2 min or 3 mins into readings. Those were coon hounds!

I-5 traffic dominates / Traffic on 33rd

## Site Sketch

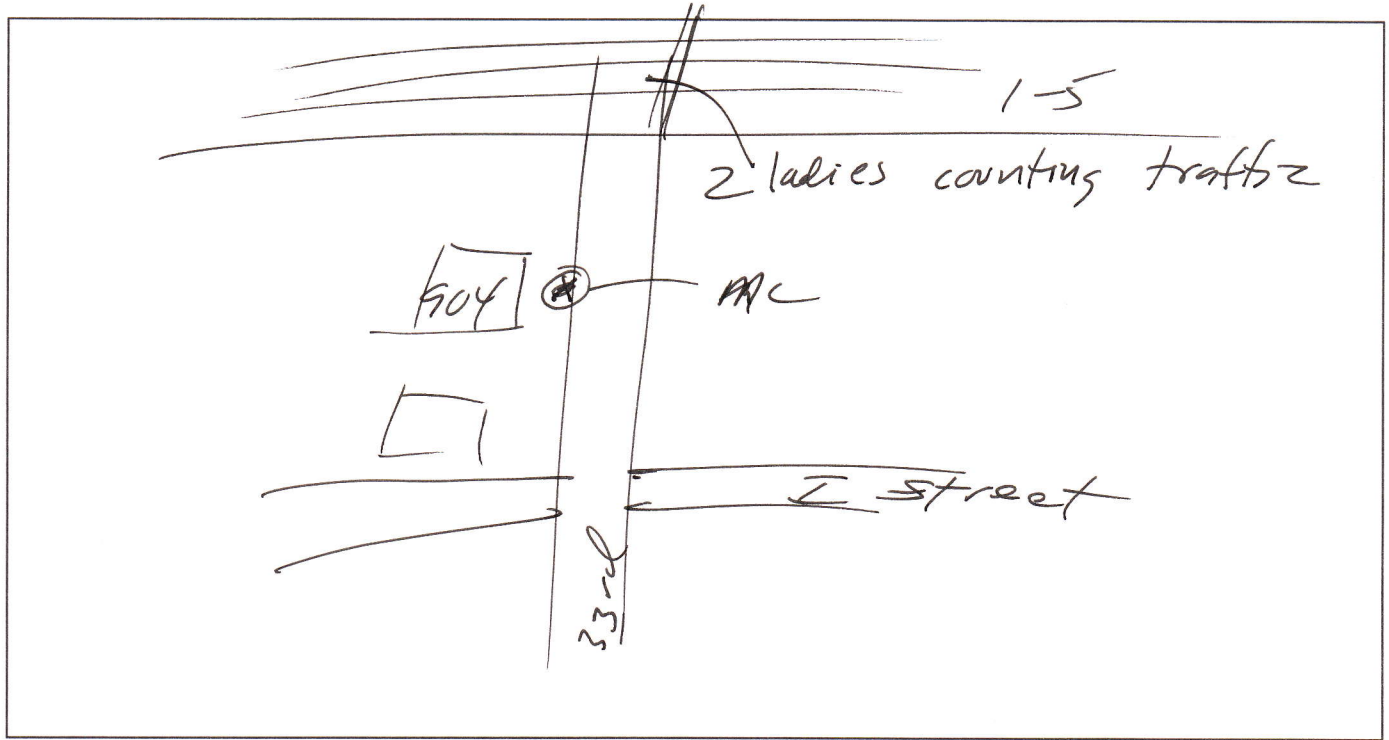

7

Traffic Noise Monitoring Information Sheet

57.9

Monitoring Location: 3306 I. St Site Number: \_\_\_\_\_

Date: 6/13/07 Start Time 15:35:53 Leq 57.7

Weather Conditions: PIc no rain

Local Traffic Counts:

Roadway Name: "I" Cars ~~75~~ MedTrucks 0 HvyTrucks 0

Roadway Name: 33rd Cars 75 MedTrucks 2 HvyTrucks \_\_\_\_\_

Area Observations: |||||

heavy car traffic 33rd Ave speed ~ 30 mph

SiteSketch

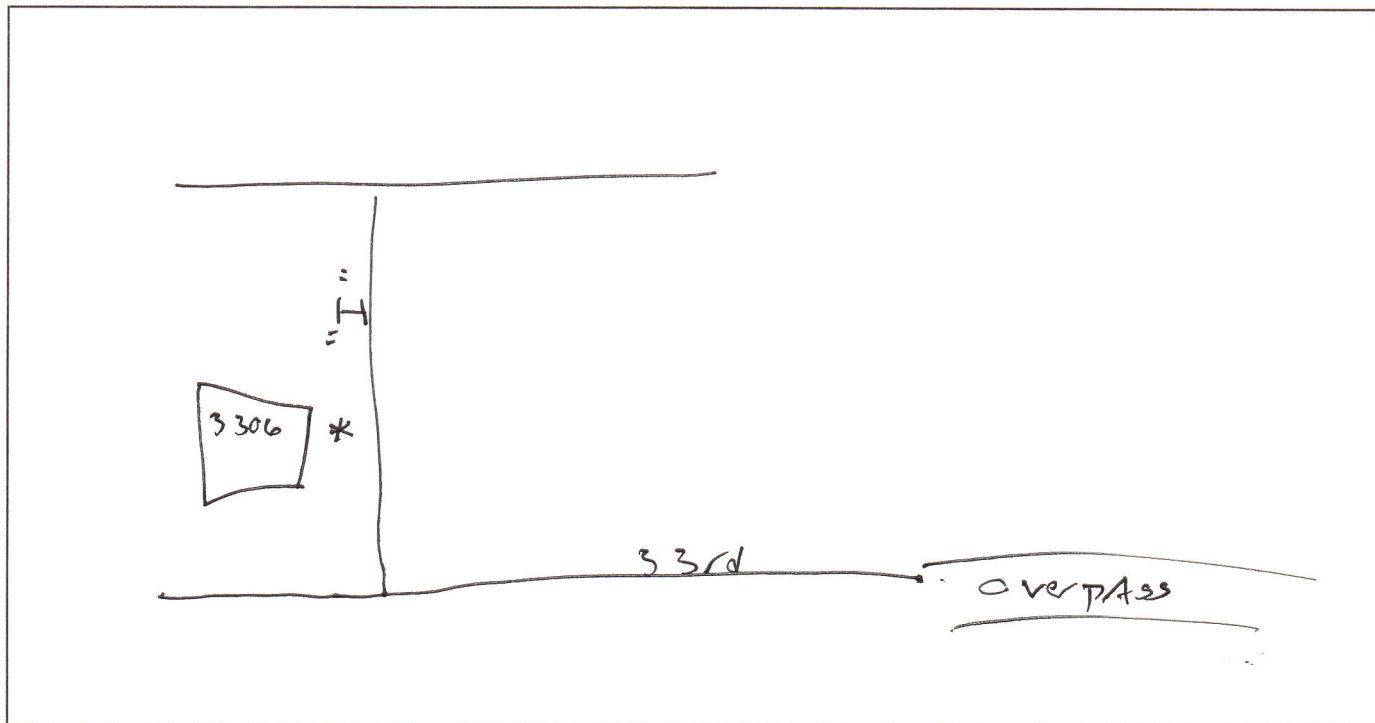

Pics 19.21

yellow small

Traffic Noise Monitoring Information Sheet

60.1

Monitoring Location: 901 E 34th Site Number: \_\_\_\_\_

Date: 6/13/07 Start Time 15:38 Leq 60.9

Weather Conditions: Same

Local Traffic Counts:

Roadway Name: I street Cars 11 MedTrucks \_\_\_\_\_ HvyTrucks \_\_\_\_\_

Roadway Name: \_\_\_\_\_ Cars \_\_\_\_\_ MedTrucks \_\_\_\_\_ HvyTrucks \_\_\_\_\_

Area Observations: \_\_\_\_\_

SiteSketch

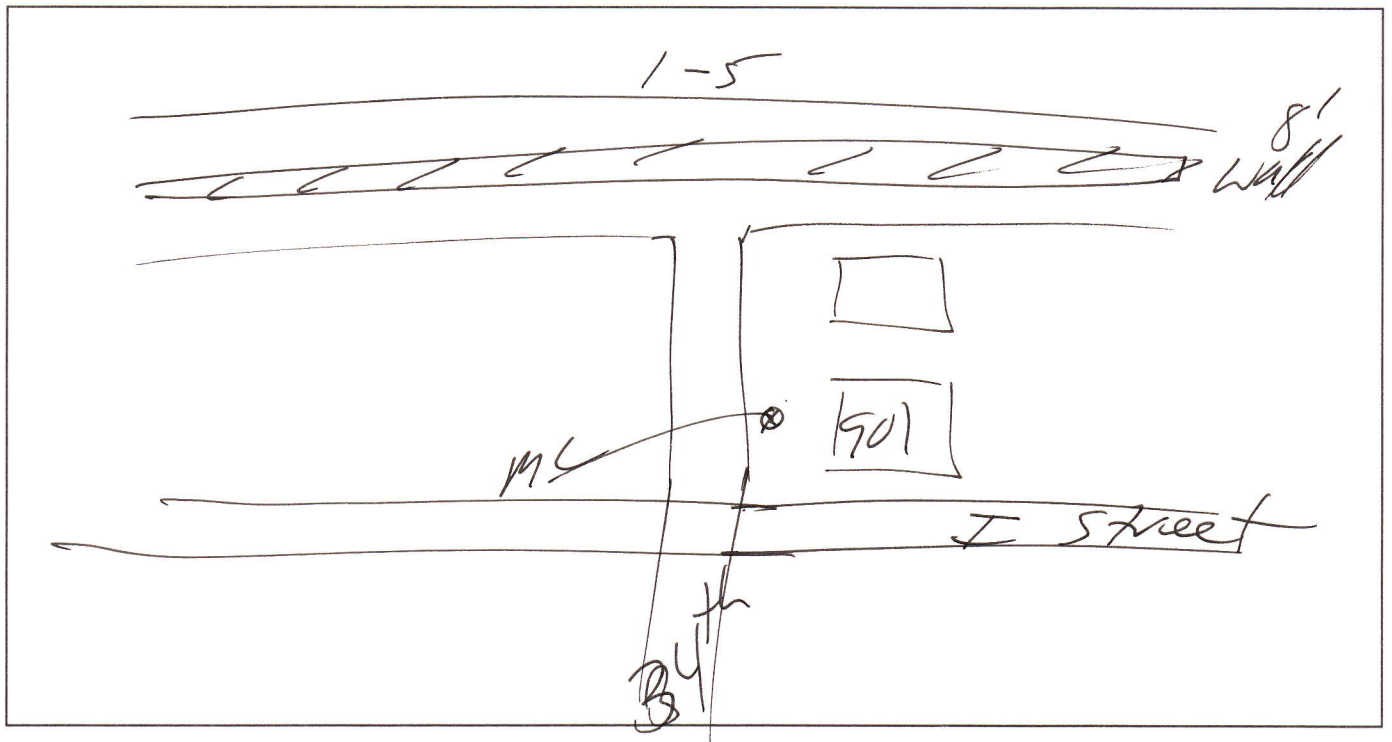

corrected 58.1  
65.6

### Traffic Noise Monitoring Information Sheet

Project Name: Columbia River Crossing

Monitoring Location: 3413 "H" St Site Number: 1

Date: 7-3-07 Start Time 1320 Leq \_\_\_\_\_

Weather Conditions: Hot, Dry

#### Traffic Counts:

Roadway Name: \_\_\_\_\_ Cars \_\_\_\_\_ MedTrucks \_\_\_\_\_ HvyTrucks \_\_\_\_\_

Roadway Name: \_\_\_\_\_ Cars \_\_\_\_\_ MedTrucks \_\_\_\_\_ HvyTrucks \_\_\_\_\_

Area Observations: Approx 100yd (W) of I-5

\* Street sweeper from 1335<sup>20</sup> - end of session

N ↑

#### Site Sketch



corrected 56.8  
63.4

### Traffic Noise Monitoring Information Sheet

Project Name: Columbia River Crossing

Monitoring Location: 811 E 36th Site Number: 2

Date: 7-3-07 Start Time 1342 Leq 58.0

Weather Conditions: \_\_\_\_\_

#### Traffic Counts:

Roadway Name: \_\_\_\_\_ Cars \_\_\_\_\_ MedTrucks \_\_\_\_\_ HvyTrucks \_\_\_\_\_

Roadway Name: \_\_\_\_\_ Cars \_\_\_\_\_ MedTrucks \_\_\_\_\_ HvyTrucks \_\_\_\_\_

Area Observations: Approx 150' (W) of I-5  
1345 - Street Sweeper

#### Site Sketch

N/A

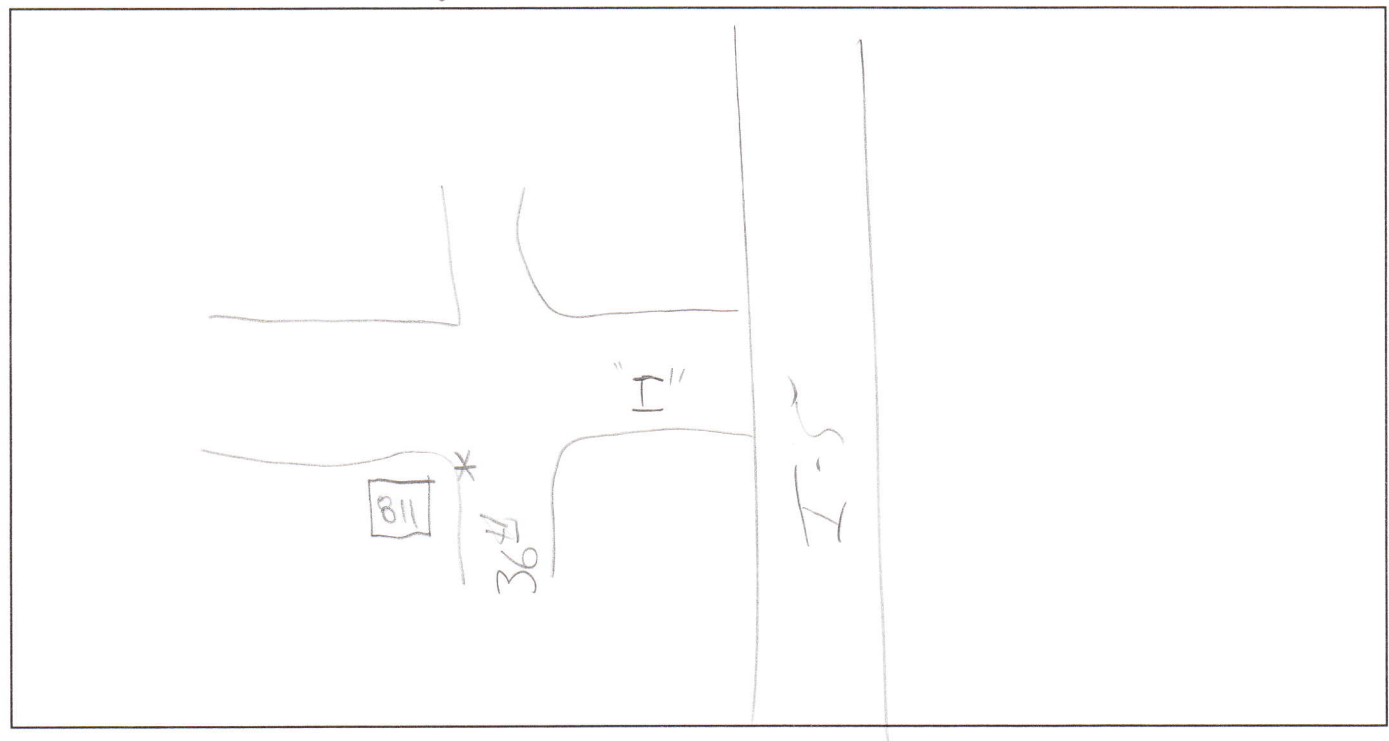



52.7

### Traffic Noise Monitoring Information Sheet

Project Name: Columbia River Crossing

Monitoring Location: 3615 "H" Site Number: 3

Date: 7-3-07 Start Time 1400 Leq 47.8

Weather Conditions: \_\_\_\_\_

#### Traffic Counts:

Roadway Name: \_\_\_\_\_ Cars \_\_\_\_\_ MedTrucks \_\_\_\_\_ HvyTrucks \_\_\_\_\_

Roadway Name: \_\_\_\_\_ Cars \_\_\_\_\_ MedTrucks \_\_\_\_\_ HvyTrucks \_\_\_\_\_

Area Observations: \* Approx 100 yds (W) of I INTERCHANGE

#### SiteSketch

N ↗



62.8

### Traffic Noise Monitoring Information Sheet

Project Name: Columbia River Crossing

Monitoring Location: 701 I ST Site Number: 4

Date: 7-3-07 Start Time 1420 Leq 63.3

Weather Conditions: \_\_\_\_\_

#### Traffic Counts:

Roadway Name: \_\_\_\_\_ Cars 56 MedTrucks 2 HvyTrucks 1

Roadway Name: \_\_\_\_\_ Cars \_\_\_\_\_ MedTrucks \_\_\_\_\_ HvyTrucks \_\_\_\_\_

Area Observations: \* Approx 90' (W) of roadway

#### SiteSketch



|||||



### Traffic Noise Monitoring Information Sheet

Project Name: Columbia River Crossing

Monitoring Location: 3801 "H" ST Site Number: 5

Date: 7-3-07 Start Time 1439 Leq 51.4

Weather Conditions: \_\_\_\_\_

#### Traffic Counts:

Roadway Name: \_\_\_\_\_ Cars \_\_\_\_\_ MedTrucks \_\_\_\_\_ HvyTrucks \_\_\_\_\_

Roadway Name: \_\_\_\_\_ Cars \_\_\_\_\_ MedTrucks \_\_\_\_\_ HvyTrucks \_\_\_\_\_

Area Observations: \_\_\_\_\_

\_\_\_\_\_  
\_\_\_\_\_



SiteSketch

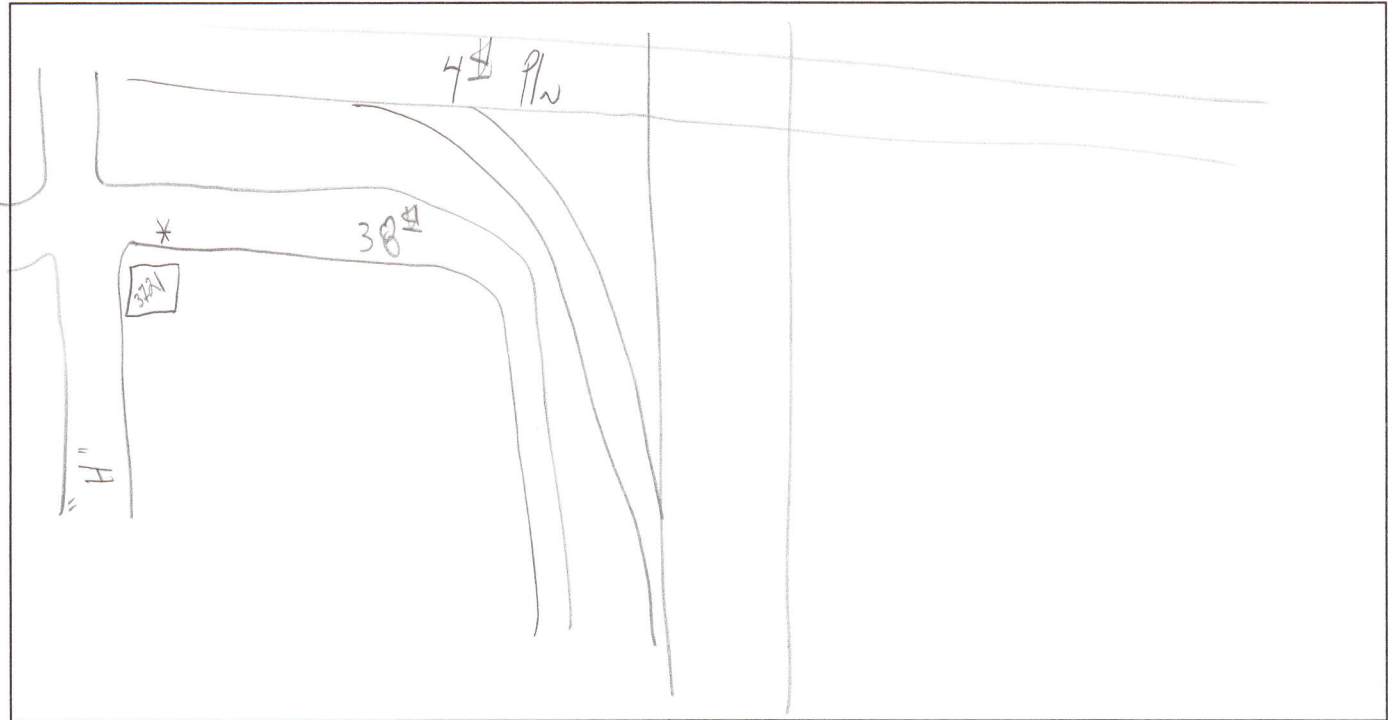

66.2

### Traffic Noise Monitoring Information Sheet

Project Name: Columbia River Crossing

Monitoring Location: 3915 "I" ST Site Number: 6

Date: 7-3-07 Start Time 1459 Leq 65.3

Weather Conditions: \_\_\_\_\_

#### Traffic Counts:

Roadway Name: \_\_\_\_\_ Cars \_\_\_\_\_ MedTrucks \_\_\_\_\_ HvyTrucks \_\_\_\_\_

Roadway Name: \_\_\_\_\_ Cars \_\_\_\_\_ MedTrucks \_\_\_\_\_ HvyTrucks \_\_\_\_\_

Area Observations: Approx 100 yd (W) of I-5, Approx 20' Above grade

Site Sketch

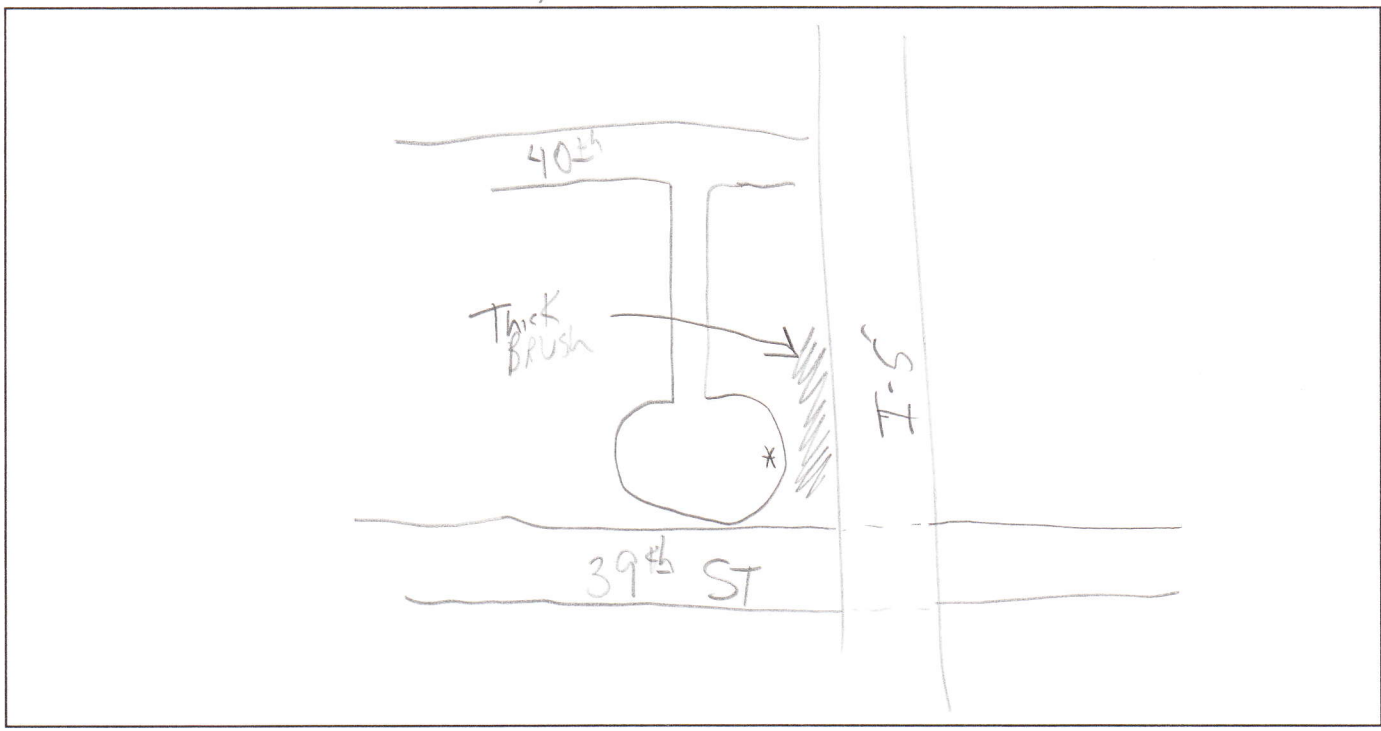



73.6

### Traffic Noise Monitoring Information Sheet

Project Name: Columbia River Crossing

Monitoring Location: DISCOVERY M. SCHOOL Site Number: 7

Date: 7-3-07 Start Time 1520 Leq \_\_\_\_\_

Weather Conditions: \_\_\_\_\_

#### Traffic Counts:

Roadway Name: \_\_\_\_\_ Cars \_\_\_\_\_ MedTrucks \_\_\_\_\_ HvyTrucks \_\_\_\_\_

Roadway Name: \_\_\_\_\_ Cars \_\_\_\_\_ MedTrucks \_\_\_\_\_ HvyTrucks \_\_\_\_\_

Area Observations: \* Approx 40 yard (W) of I-5

#### Site Sketch

NA

